

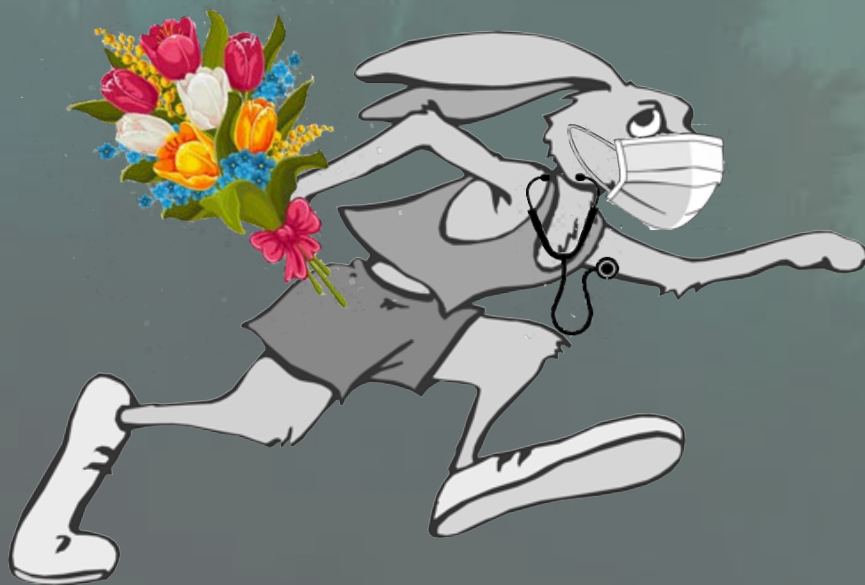

*** ATTENTION EXHIBITORS ***

IN THE EVENT THAT OUR LURE FIELD TRIAL HAS TO BE CANCELLED DUE TO THE COVID-19 PANDEMIC ALL ENTRY FEES WILL BE REFUNDED

NOTIFICATION WILL BE EMAILED THROUGH DOGSHOW.CA AND POSTED ON THE WESTERN CANADIAN LURE COURSING CLUB FACEBOOK PAGES



Official Premium List



ALBERTA LURE COURSING ASSOCIATION

Announces

TWO CKC LURE FIELD TRIALS May 23rd and 24th, 2020
(Outdoors)

These Events Held Under the Rules of the Canadian Kennel Club

To Be Held At:
Bremner House

53452 Rge Rd 225, Sherwood Park, AB T8A 4V3
Co-Ordinates: Lat 53 deg, 36', 30.0" N, Long -113 deg, 13', 29.0" W

Mail ALL Entries To:
Miriam Woestenburg,
12927-78 St. Edmonton, AB, T5C 1G6
(780) 456-2866
E-mail: minidragon@shaw.ca

Secure on-line entry service available at
www.dogshow.ca (VISA, Mastercard, American Express & Interac)



Field Trial Pre-Entry Closes: Wednesday May 20th 2020

Post Entry Closes:	Saturday	8:30 a.m.	Official Classes
		10:00 a.m.	Singles
	Sunday	8:30 a.m.	Official Classes
		10:00 a.m.	Puppy, Veteran
Roll Call:	Saturday	9:00 a.m.	Official Classes
			Singles - immediately following preliminary courses
	Sunday	9:00 a.m.	Official Classes
			Puppy, Veteran - Immediately following preliminary courses

Rolling Inspection from arrival to Roll Call

LURE TRIAL OFFICIAL CLASSES OFFERED

Open Stake - for all eligible hounds one year of age or older, including Field Champions. If there are multiple breeds with entries of three or less, upon agreement of all owners, they will be combined in a **Mixed Stake**.

LURE TRIAL UNOFFICIAL CLASSES OFFERED

Best In Field – Offered on Sunday. Best of Breed and Mixed Stake winners from both days are eligible.

Singles – Saturday after completion of preliminary courses. See **Conditions & Information** for details.

Puppy – (6-9, 9-12, 12-18 months) - Sunday after completion of preliminary courses– run singly

Veteran – (eligible for dogs 7 years and older) - Sunday after completion of **Puppy Class** – run singly

Kennel Stake, Breeder Stake - Sunday – 2 dogs, Highest Score

Club Stake - Sunday – 3 dogs, top 2 scores

- Combinations to be named before first course runs on Sunday

ENTRY FEES:

LURE FIELD TRIAL

Pre-entry, first hound (closes May 20th) \$22.00 (includes CKC recording fee)

Pre-entry, each additional hound same owner/co-owner \$20.00 (includes CKC recording fee)

Post entry (after May 20th) \$35.00 (includes CKC recording fee)

***TCN (Temporary Competition Number) Fee per Show per Dog**

(required for any dog without an individual CKC Registration No,
Miscellaneous No. or ERN) \$10.00

SINGLES (Limited Entry) \$10.00

PUPPY, VETERAN, KENNEL, BREEDER, CLUB \$ 5.00

**** TEMPORARY COMPETITION NUMBERS (TCN) ****

With the implementation of CKC's IT system, a new process requires all owners of unregistered, recognized breeds entering events to obtain a Temporary Competition Number (TCN). TCNs will replace the current system of entering events with "listed dogs", and will allow dogs to temporarily participate in CKC events while they pursue permanent CKC registration or an Event Registration Number (ERN).

A TCN must be obtained BEFORE submitting an entry for any event and the same TCN must be used for all event entries for a dog until the dog is permanently registered. Once a dog is permanently registered or has an ERN, the TCN will be replaced with the registration number or ERN. A TCN cannot be used for Listed Breeds (MCN) or dogs that will require a (Performance Event Number) PEN or (Canine Companion Number) CCN.

While there is no fee to obtain a TCN, exhibitors will still be required to pay TCN Fees (formerly called listing fees) when entering events using this number.

The process of obtaining a TCN will be self-serve; exhibitors will be directed to the CKC website to complete an online application and a TCN will be issued instantly upon completion.

Exhibitors may also obtain a TCN by completing a printed application and submitting it to the CKC via mail, or by contacting the Shows and Trials Division by telephone.

Please note that if your dog does not have a registration number or ERN, and has already competed in a CKC event and earned points, scores, or awards, there is no need to apply for a TCN. CKC records will be updated accordingly.

If you have any questions regarding Temporary Competition Numbers, please contact the Shows and Trials division at 416-675-5511, 1-855-364-7252 (toll-free), or email at information@ckc.ca.

COURSING JUDGES:

Karen Douglass	Ponoka, AB	KD
Barbara (Bobbi) Westman	Edmonton, AB	BW
Pat Ingram	Calgary, AB	PI

JUDGING ASSIGNMENTS:

Breeds	Saturday May 25	Sunday May 26
Afghan Hound	PI BW	PI BW
Azawakh	PI BW	PI BW
Basenji	PI BW	PI BW
Borzoi	PI BW	PI KD
Deerhound (Scottish)	PI BW	PI BW
Greyhound	PI KD	PI KD
Ibizan Hound	KD BW	KD BW
Irish Wolfhound	PI BW	PI BW
Italian Greyhound	PI KD	PI KD
Pharaoh Hound	PI BW	PI BW
Rhodesian Ridgebacks	PI BW	PI BW
Saluki	PI BW	PI BW
Whippet	PI KD	PI BW
Mixed Stakes	TBA	TBA
Singles	TBA	TBA

Dog ShowTM.ca

ENTER ONLINE @ WWW.DOGSHOW.CA

TOLL FREE FAX: 1-877-99-ENTRY (36879)

A service charge of 10% will be assessed. This includes entries sent online, by fax or post using a credit card or Interac for payment.

HERE'S YOUR CHANCE TO ATTEND

The World Dog Show 2021

— IN BRNO, CZECH REPUBLIC! —

Dog ShowTM.ca

15TH
Anniversary

ENTER YOUR NEXT SHOW ONLINE
WITH US FOR YOUR CHANCE TO WIN.

GRAND PRIZE A trip for two to the World Dog Show 2021 in Brno, Czech Republic.

— NO MEMBERSHIP FEES! —

No purchase required. Valid in Quebec. Prize valued at \$4500. Full contest details available @ www.DogShow.ca/en/contest

ROLL CALL TIMES and RUNNING ORDER

We are offering a Rolling inspection between the time you arrive and Roll Call.

Official Classes: **Post Entry:** closes at **8:30 am.** **Roll Call at 9:00 a.m.**
Singles (Saturday): **Post Entry:** closes at **10:00 am.**
Puppies & Veterans (Sunday): **Post Entry:** closes at **10:00 am.**

Breed running order will be posted at Roll Call.

Singles (Saturday) – Immediately following preliminary courses.

Puppy & Veterans (Sunday) – Immediately following preliminary courses.

Best in Field will be run on Sunday only. Open to all Breed and Mixed Stake winners from both Saturday and Sunday.

CERTIFICATION RUNS

Certification runs **by appointment only** Friday evening. Cost is \$15.00. Please make your own arrangements for a suitable dog to run yours with. Call Ed at 780 922-5218 to make the arrangements. CKC requirements for eligibility under **FAQ's**.

PRIZES & AWARDS

OPEN: **Best Of Breed, First in Mixed Stake and Best in Field:** Rosette & prize
Second to Next Best Qualifier: Rosette
Qualifying Score: Ribbon will be offered for each **qualifying score** earned by a hound which has not previously earned the Novice Courser Title. Please let the Field Trial Secretary know if your hound qualifies.

SINGLES: **Highest scoring Singles run:** Rosette
2nd to NBQ: Ribbon

BEST PUPPY: Highest score for a **Puppy in Field:** Rosette & prize
First to Next Best Qualifier in each age class: Ribbon

BEST VETERAN: Highest score for a **Veteran in Field:** Rosette
2nd to NBQ: Ribbon

NOVICE: **Highest Weekend Aggregate Score for a Hound competing in its First Trial Weekend:** Rosette. Scores adjusted for judge's averages.

KENNEL STAKE: Rosette
BREEDER STAKE: Rosette
CLUB STAKE: Rosette

2020 AGGREGATE AWARD: A large Rosette will be awarded for High Point Aggregate. To be awarded to the hound qualifying in all of ALCA's 2020 trials. Award will be determined by total scores adjusted for judges' averages.

FIELD TRIAL COMMITTEE AND OFFICIALS		ALBERTA LURE COURSING ASSOCIATION 2020 EXECUTIVE	
Field Trial Chair	Ed Molloy	President	Bobbi Westman
Field Trial Committee:	Ed Molloy Cherie Hunchak Lynda Webster Cindy Kremer	Vice President	Brendan Molloy
Field Clerk	Ivy Molloy Navidka Algu	Secretary	Cindy Kremer
Field Trial Secretary	Miriam Woestenburg	Treasurer	Ivy Molloy
Lure Operators	Cherie Hunchak Ed Molloy		
Hunt Master	Brendan Molloy Piet Woestenburg		
COMPLAINTS COMMITTEE: Ed Molloy, Cindy Kremer, Bobbi Westman, Cherie Hunchak			

ATTENTION

It shall be the duty and obligation of the trial-giving club to see that a judge, club official, volunteers or any participant at the CKC any infringement of this regulation, and the Discipline Committee shall have the authority to take such action as it deems fit on the receipt of a report indicating that this has occurred.

CANADIAN KENNEL CLUB OFFICIALS:

THE CANADIAN KENNEL CLUB EXECUTIVE DIRECTOR

Mr. Lance Novak, 200 Ronson Drive, Suite 400, Etobicoke, ON, M9W 5Z9 (416) 675-5511

THE CANADIAN KENNEL CLUB DIRECTOR FOR ALBERTA

Sharon Derrick, 60 Riverview Cl SE, Calgary, AB, T2C 4C4, Tel: (403) 236-7280, sderrick@shaw.ca

ALBERTA LURE COURSING REPRESENTATIVE

Ed Molloy 169-52061 RR215 Sherwood Park, AB T8E 1B2, Tel: (780) 922-5218, andare@syban.net

AVAILABLE VETERINARY SERVICES

Vet Emerg 780 423 9111, 12831 97 St Nw Edmonton

Guardian Veterinary Centre 780 436 5880, 5620 99 St Edmotnon

DIRECTIONS TO THE FIELD

This field is north east of Sherwood Park. Shopping, gas & coffee are less than 10 min away.

From South: Hwy 21 north to Hwy 16.

East on Hwy 16 to Range Road 225 (approx. 2 km)

Turn left (north) on Range Road 225.

Field is 4 km north of Hwy 16 on left side of road. Entrance has **SVTA** in big letters over the gate.

EQUIPMENT AND FIELD CONDITIONS

The field is a mown hay field, flat on the west side, sloping towards the road.

An electric drag will be used for the Regular Classes and Singles.

A continuous loop may be used for the Puppy and Veteran stakes.

CONDITIONS AND INFORMATION

- There will be a concession on the field.
- Rolling inspection – check in for inspection as you arrive, with your dog(s). Inspection ends ½ hour after entries close each day (roll call). It is your responsibility to take your dog for inspection prior to roll call.
- All hounds will be run in trios or braces, twice, unless excused, dismissed or disqualified.
- Hounds not present at roll call will be scratched, and their entry fee will NOT be refunded. No exceptions will be made.
- All handlers MUST use a slip lead when releasing their hounds.
- Hounds may wear muzzles and/or catch collars at the owner/agent's discretion.
- **Singles:** Is your dog DQ'd, declared ineligible or not ready for running in competition? This is the place to be! Dogs will be run individually and scored by an experienced volunteer judge. A random draw will determine the order of running of dogs in this stake. No points are awarded and all ties will be settled by a coin toss. Your dog will be given TWO opportunities to chase the lure when it comes to the line. Handlers may not run/walk the course with their hounds. Entry limited to 8 dogs.
Dog will only run once.
- Bitches in season and lame hounds will be excused and will have their entry fee returned if notice is given to the secretary **prior** to roll call. A Veterinarian certificate may be required.
- The Chair may excuse any hound from competition for any reason deemed justifiable.
- A \$10.00 fine, payable to ALCA, will be levied for any hound loose on the field at any time between Roll Call and the completion of Best in Field or Regular classes.
- There is limited shade and no water available, so please come PREPARED.
- There will be limited overnight camping. Please contact Ed Molloy to reserve your spot. (780-922-5218).

*** ATTENTION EXHIBITORS ***

IN THE EVENT THAT THE TRIAL HAS TO BE CANCELLED DUE TO THE COVID-19 PANDEMIC ALL ENTRY FEES WILL BE REFUNDED

COURSE LAYOUTS

Courses subject to change depending on weather and safety considerations

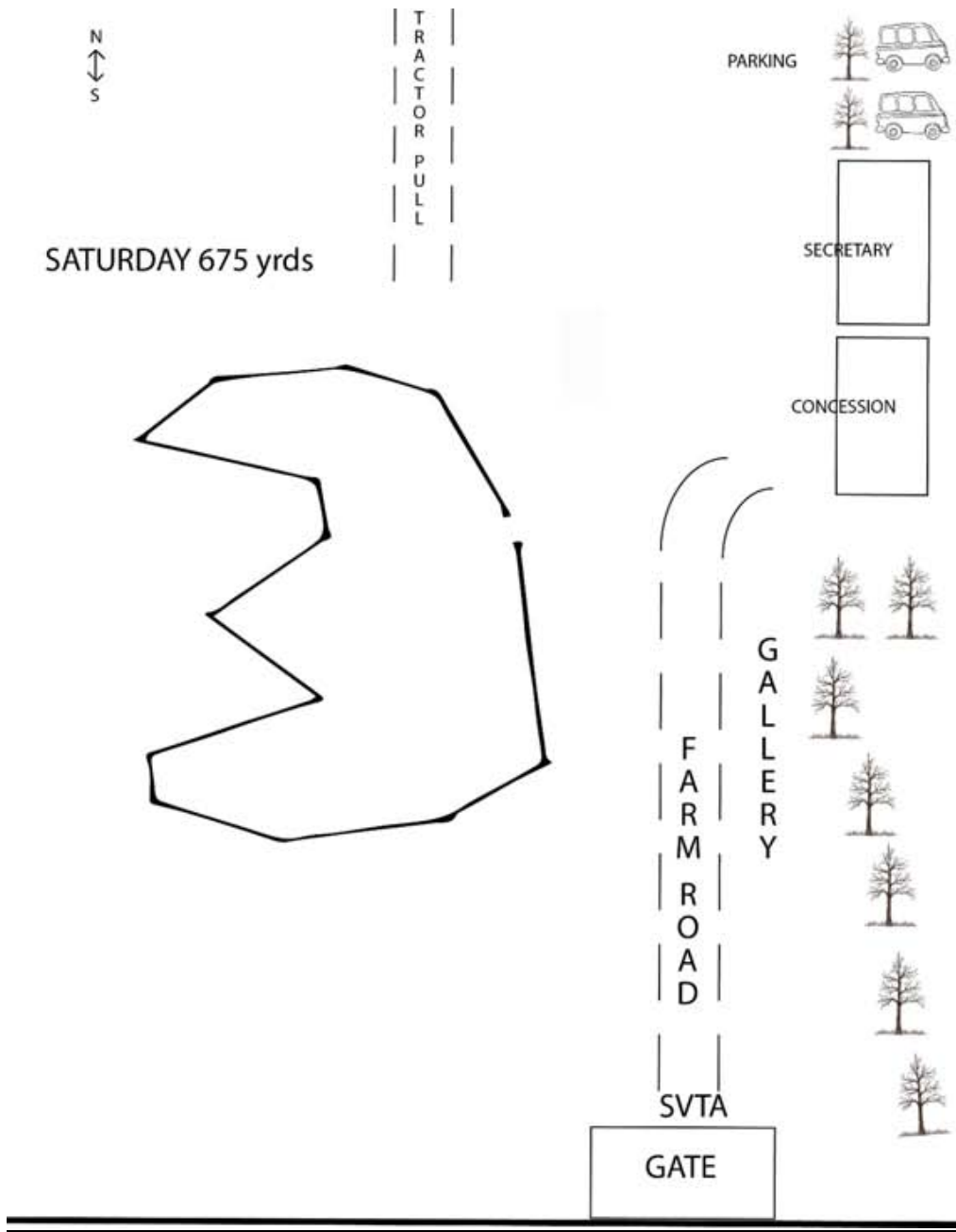

Sunday 800 yards

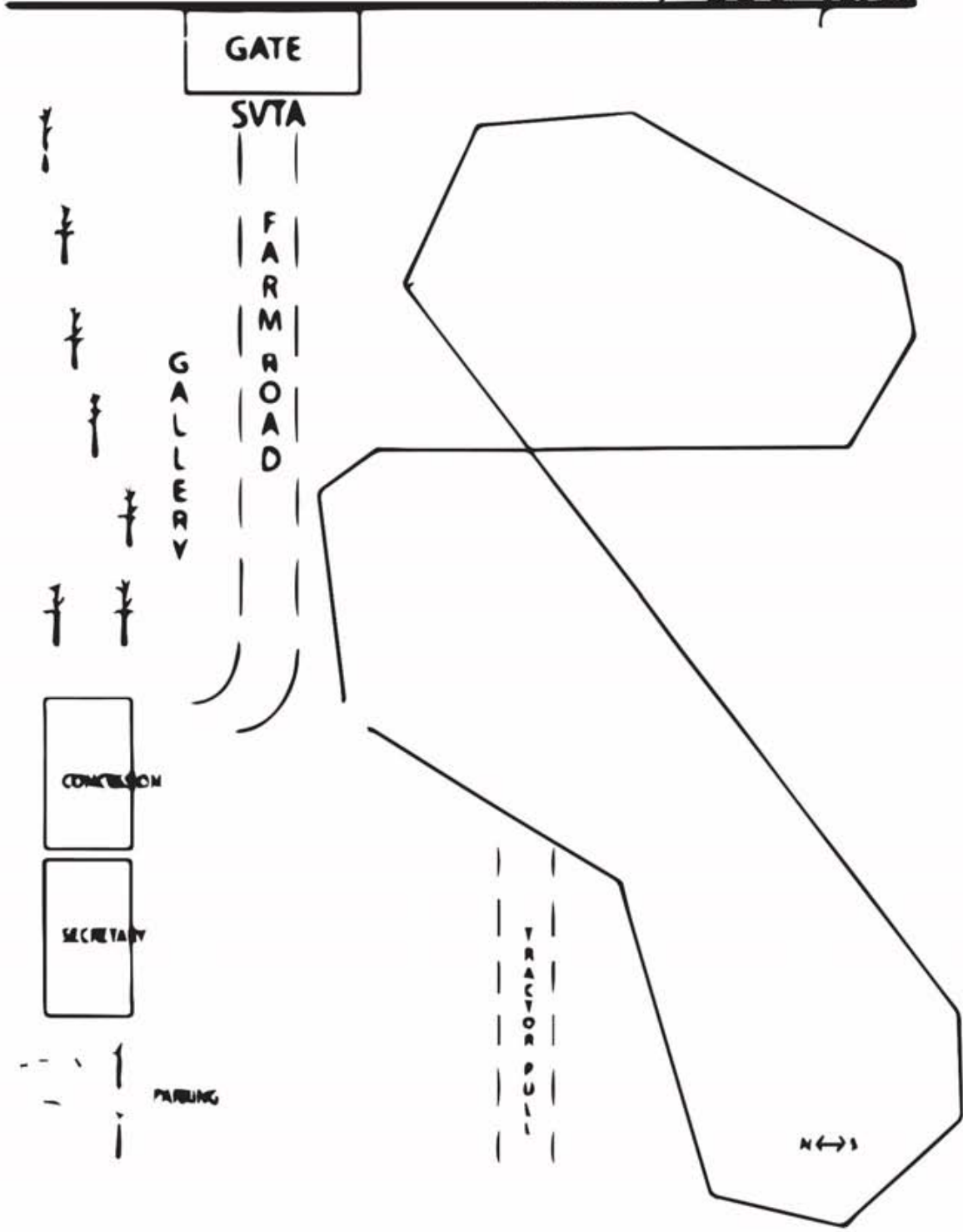

**ALL RULES GOVERNING THESE EVENTS
ARE AVAILABLE ON LINE FROM THE CANADIAN KENNEL CLUB**
<https://www.ckc.ca/en/Files/Forms/Shows-Trials/Event-Rules-Regulations/Lure-Coursing-Field-Trial-Rules-and-Regulations.aspx>

**FOR YOUR CONVENIENCE RULES PERTAINING TO SOME
FAQ'S ARE PRINTED BELOW**

7.1 Eligibility of Hounds

7.1.1 To be eligible to compete at approved lure coursing field trials a dog must meet the following requirements:

- (a) A hound must be tested with another dog, of the same breed or a breed with a similar running style (preferably not a kennelmate) and certified running clean by a licensed judge. Hounds must be a minimum of 11 months old prior to being certified, and must run a course of at least 600 yards (548.4 m) in order to be certified.
- (b) A certificate signed by the judge is given to the owner at the time of the test and must be submitted to the Field Trial Secretary at the dog's first trial.
- (c) All dogs must be one year of age on the date of the trial to enter a regular stake and must be registered or eligible for registration in the records of the CKC as hereinafter provided.

1.1 Definitions

"hound" means when used in these rules: Afghan Hounds, Azawakhs, Basenjis, Borzois, Deerhounds (Scottish), Greyhounds, Ibizan Hounds, Irish Wolfhounds, Italian Greyhounds, Pharaoh Hounds, Rhodesian Ridgebacks, Salukis and Whippets.

ATTENTION CANADIAN EXHIBITORS – INFO REGARDING TITLES

The following is quoted from the CKC website:

"The following non-member participation fee now applies and is retroactive to January 1, 2011.

The non-member participation fee applies to all Canadian residents who participate in a CKC event but are not CKC members and a participating non-member can choose to purchase a CKC membership or pay the non-member fee. This only applies to dogs wholly owned by non-members and is not applicable to CKC members or dogs co-owned with a CKC member. In order for the CKC to efficiently manage recording and tracking points, it's important that non-members select one of the two options within 30 days of notification or, unfortunately, we will be forced to cancel any awards and titles

Non-Member Participation Fee

24-12-3. Non-member participation fee

- a) An annual non-member participation fee for awards and titles will be charged to a Canadian non-member of CKC. The fee will match the ERN fee.*
- b) In order to protect the awards/titles earned, the non-member will have a choice either to become a CKC member or to pay the non-member participation fee. Failure to comply within 30 days of notification will cause all awards and titles to be canceled.*
- c) The Premium List must carry a note stating that "these fees apply only to dogs wholly owned by non-CKC members and are not applicable to CKC members."*

EVENT REGISTRATION NUMBERS (ERN)

All dogs that are foreign born and foreign owned and enter Canada for the sole purpose of entering CKC events do not require a CKC registration number but will require an Event Registration Number (ERN).

To obtain an ERN simply mail a copy of the dog's registration certificate with a cheque money order or VISA/Mastercard number (expiry date, cardholder's name and signature) in the amount of \$59.40 + GST payable to the Canadian Kennel Club. This Event Registration Number MUST be applied for with 30 days of the first day of entering a CKC Event. Please forward your request to The Canadian Kennel Club, Shows and Trials Division 100-89 Skyway Avenue, Etobicoke, Ontario M9W 6R4, Fax: (416) 675-6506.

Chapter 9.5 Placements and Awards

9.5.1 Hounds which are not to be scored are not to be added to a course.

9.5.2 Championship points in regular stakes shall be awarded on the basis of the following:

First Place: Four times the number of hounds competing in the stake with a maximum of 40 points.

Second Place: Three times the number of hounds competing in the stake with a maximum of 30 points.

Third Place: Twice the number of hounds competing in the stake with a maximum of 20 points.

Fourth Place: Points equal to the number of hounds competing in the stake to a maximum of 10 points.

Next Best Qualified Dog (NBQ): No points awarded.

Qualifying Score (QS): No points awarded.

9.5.3 A hound shall not receive a placement or be awarded points if it does not score at least 50 per cent of the total possible combined scores. Hounds which do not receive placements under this provision will, nevertheless, be considered as having been in competition for the purpose of awarding points. If a hound is excused in the preliminary run, that hound will not count as having been in competition when computing championship points. Hounds that are dismissed or declared ineligible shall count as having been in competition when computing championship points.



Official Canadian Kennel Club Entry Form
Alberta Lure Coursing Association



May 23rd & 24th, 2020
 Sat ___ Sun ___

ENTER IN THE FOLLOWING CLASSES: One entry form per hound

I Enclosed \$ _____ for Entry Fees \$ _____ TCN Fees \$ _____ Other \$ _____

PLEASE TYPE OR PRINT CLEARLY

Regular Classes	Open <input type="checkbox"/>	\$ 22.00 =
Unofficial Classes		
<input type="checkbox"/> Puppy 6-9 months		\$ 5.00 =
<input type="checkbox"/> Puppy 9-12 months		\$ 5.00 =
<input type="checkbox"/> Puppy 12-18 months		\$ 5.00 =
<input type="checkbox"/> Veteran		\$ 5.00 =
<input type="checkbox"/> Single		\$10.00 =
<input type="checkbox"/> Breeder Stakes		\$ 5.00 =
<input type="checkbox"/> Kennel Stakes		\$ 5.00 =
<input type="checkbox"/> TCN Fee (dog without a CKC Number) PER EVENT		\$10.50 =
Total		\$ _____

Enclose \$ _____ for Entry Fees \$ _____ TCN Fees \$ _____ Other \$ _____

Visa Mastercard American Express

Card No. _____ Expiry _____ / _____

CARDHOLDER NAME (PLEASE PRINT):

Breed:	Call Name:	<input type="checkbox"/> Male <input type="checkbox"/> Female
--------	------------	---

Registered Name of Hound:

Check one & enter Number here:

Is this dog's first trial? Yes No
 If Yes, bring or attach Hound Certification
 Please separate my hounds

<input type="checkbox"/> CKC Reg. No.	Date of birth D ___ M ___ Y _____	Is this a puppy? Yes <input type="checkbox"/> No <input type="checkbox"/>
<input type="checkbox"/> CKC ERN No.		
<input type="checkbox"/> CKC Misc. Cert. No.	Place of Birth:	Owner's CKC Membership No.
<input type="checkbox"/> CKC PEN No.	Canada <input type="checkbox"/>	
<input type="checkbox"/> TCN	Elsewhere <input type="checkbox"/>	

Breeder(s): _____
 Sire: _____
 Dam: _____
 Reg'd Owner(s): _____ Email: _____
 Owner's Address: _____

City: _____ Prov: _____ Postal Code: _____

Name of Owner's Agent (if any) at the Trial _____ Email _____

City _____ Prov _____ Postal Code _____

I CERTIFY that I am the registered owner(s) of the dog or that I am the authorized agent of the owner(s) whose name(s) I have entered above and accept full responsibility for all statements made in this entry. I CERTIFY that one of the owners has the CKC membership number listed above. In consideration of the acceptance of this entry, I (we) agree to be bound by the rules and regulations of the Canadian Kennel Club and by any additional rules and regulations appearing in the premium list.

*****IDs will not be mailed – please supply email address for entry confirmation*****

Signature of Owner or Agent _____ Phone _____



Alberta Lure Coursing Association - Accidental Waiver & Release of Liability Form

In consideration of the acceptance of this Alberta Lure Coursing Association (ALCA) membership and or individual practice/fun(s) runs, the holding of this event(s), official trials, and the opportunity to have the canine(s) run, I agree to hold the organizing committee, the organization which it represents, including its members, officers and directors, volunteers, owners of the premises upon which the event(s) is held and their employees, harmless from any claim for loss or injury which may be alleged to have been caused directly or indirectly to any person or thing by the act of this dog while in or upon the event premises, or grounds, or near any entrance thereto, and I personally assume all responsibility and liability for any such claim.

I further agree to hold the aforementioned parties harmless from any claim for loss of this dog by disappearance, theft, death, or otherwise, and from any claim for damage or injury, to be caused or alleged to be caused by negligence of the parties aforementioned, or by the negligence of any other person, or any other cause or causes.

I hereby assume the sole responsibility for and agree to indemnify the aforementioned parties hold harmless from any and all loss and expenses (including legal fees) by reason of the liability imposed by law upon any of the aforementioned parties for damage because of bodily injuries, including death at any time resulting there from sustained by any person or persons, including myself and my guest or on account of damage to property, arising out of or in consequence of my participation in this event, howsoever such injuries, death or damage to property may be caused or may have alleged to have been caused by negligence of the aforementioned parties or any of their employees or agents, or any other person.

I hereby consent to receive medical treatment, which may be deemed advisable in the event of injury, accident, and/or illness during this activity.

I understand while participating in this activity, I or my canine(s) may be photographed. I agree to allow my photo, video, or film likeness to be used for any legitimate purpose by the activity holders, producers, sponsors, organizers, and assigns.

The Accident Waiver and Release of Liability Form shall be construed broadly to provide a release and waiver to the maximum extent permissible under applicable law.

Name: _____ Phone: _____ Email: _____

Name of Canine(s)

#1 _____ Any Canine Health Related Issues: _____

#2 _____ Any Canine Health Related Issues: _____

#3 _____ Any Canine Health Related Issues: _____

I certify that I have read this document and I fully understand its content. I am aware that this is a release of Liability and a contract and I sign it of my own free will.

Signature: _____

Date: _____ 2020

Signature of parent/guardian is required for children under 18 years