

OFFICIAL PREMIUM LIST

MANITOBA GAZEHOUD ASSOCIATION

2 LICENSED LURE COURSE TRIALS

Saturday MAY 11th & Sunday MAY 12TH, 2019

MORRISON SPORTS PARK

OAKVILLE, MANITOBA

JUDGES:

Pat Ingram, Box 12, Site 27, RR7, Calgary, AB T2P 2G7

Christine Gillies - 385 Amherst St, Winnipeg, MB R3J 1Z1

LURE OPERATOR:

Karl Schnablegger

Send Entries to:

**EVENT SECRETARY
Candace Cook
Box 12, Group 553, RR5
Winnipeg, MB R2C 2Z2
204-222-4789
shakula@mts.net**

ENTRIES CLOSE: Friday, MAY 10th, 2019

Entries will not be accepted by phone

*****No Field/Post Entries Accepted*****

Roll Call:

Saturday - May 11, 2019 - 9:00 AM

Sunday - May 12, 2019 - 9:00 AM

These events are held under the rules of The Canadian Kennel Club.

*****RHODESIAN RIDGEBACKS ARE NOW ELIGIBLE TO PARTICIPATE IN CANADIAN LURE COURSING TRIALS*****

ELIGIBLE BREEDS: The Lure Course Trial Program participation is open to all breeds designated as Sighthounds who are at least 12 months of age that are:

- individually registered with the CKC; or
- have an Event Registration Number (ERN); or
- have a Performance Event Number (PEN); or
- eligible for registration with the CKC; or
- have a Miscellaneous Certificate Number (MCN) if it belongs to a CKC listed breed.

STAKES OFFERED:

- Open Stakes:** Each stake shall consist of entries for only one breed (dogs and bitches). Field Trial Champions in that breed may be entered.
- Singles:** Dogs will be run individually and scored by a judge. Hounds will run after the Open Stake has completed its preliminary round and then again after the open stake has completed its final round. A random draw will determine the order of running of dogs in this stake. Dogs must wear a blanket.
- Veteran:** Each stakes shall consist of entries of only one breed (dogs and bitches) where their age is over 7 years. Field Trial Champions in that breed may be entered.
- Best in Field:** For all Best of Breed winners

Dogs with Breed disqualifications are eligible to enter.

Females in season may not enter.

A dog may enter only once per trial.

Running order and arrangement of hounds coursing shall be determined by a random draw conducted by the Field Trial Secretary. 1st drawn will wear yellow (running on left side), 2nd drawn will wear pink (running in the middle) and 3rd drawn will wear blue (running on the right side).

PLACEMENTS & AWARDS

CKC Chapter 9 Section 9.5.2 Championship points in regular stakes shall be awarded on the basis of the following:

- First Place:** 4x the number of hounds competing in the stake with a maximum of 40 points.
- Second Place:** 3x the number of hounds competing in the stake with a maximum of 30 points.
- Third Place:** 2x the number of hounds competing in the stake with a maximum of 20 points.
- Fourth Place:** Points equal to the number of hounds competing in the stake to a maximum of 10 points.
- Next Best Qualified Dog (NBQ):** No points awarded
- Qualifying Score (QS)** No points awarded

CKC Chapter 9 Section 9.5.3 A hound shall not receive a placement or be awarded points if it does not score at least 50% of the total possible combined scores. Hounds that do not received placements under this provision will, nevertheless, be considered as having been in competition for the purpose of awarding points. If a hound is excused in the preliminary run, that hound will not count as having been in competition when computing championship points. Hounds that are dismissed or declared ineligible shall count as having been in competition when computing championship points.

RIBBONS:

A Rosette will be provided for Best in Field.

Ribbons will be provided for Best of Breed and placements 1st thru 4th, NBQ & QS.

Prizes will be provided for Best in Field and Best in Breeds.

PRE-CERTIFICATION OF HOUNDS:

Pre-certs will be run on Saturday. If anyone requires a dog be certified prior to trial please contact the Trial Secretary to make arrangements.

COURSE PLANS: The club reserves the right to alter the course plan as required by weather and/or field conditions on the day of the trial. Course will be reversed for finals and again for run-offs and BOB.

Field is mowed grass.

ATTENTION EXHIBITORS:

- There will be a \$10.00 fine for dogs loose on the field or in the area of the event other than the dog running the course.
- Dogs will be run once per test.
- Lamé dogs or bitches in season will be excused and their entry refunded, provided notice is given prior to or during roll call.
- Dogs not present at roll call shall be scratched with no refunds. No exceptions.
- Muzzles and catch collars may be used at the handler's discretion. NO FLEXI LEADS, SHOCK COLLARS OR PRONG COLLARS ALLOWED.
- Catch collars must be free of any item that could become entangled in the line (e.g. tags)
- A veterinary clinic is located in the town of Portage la Prairie.
- There is plenty of parking. Bathrooms available.
- Lots of room for crates but bring shade for your dogs and plenty of water.
- People are expected to clean up after their dogs. There will be a \$10.00 fine for caught NOT cleaning up after their dogs.

DIRECTIONS TO THE FIELD

Traveling West from Winnipeg: Head west on Trans Canada HWY #1 towards Portage la Prairie for approximately 55 km (from West Perimeter).

Turn left onto HWY 13 (south). There are signs for Oakville/Carman.

After 2.5 km turn right (west) onto HWY 331. There is a sign for Newton.

Park entrance is on the left hand side (south) very near this intersection.

Traveling East from Portage la Prairie: Head east on Trans Canada Hwy #1 towards Winnipeg. It is approximately 32 km from the CanadInn to HWY 13.

Turn right onto HWY 13 (south). There are signs for Oakville/Carman.

After 2.5 km turn right (west) onto HWY 331. There is a sign for Newton.

Park entrance is on the left hand side (south) very near this intersection.

JUDGING ASSIGNMENTS

<u>Breed</u>	<u>Saturday</u>	<u>Sunday</u>
Afghan Hound	PI/CG	PI/CG
Basenji	PI/CG	PI/CG
Borzo	PI/CG	PI/CG
Deerhound - Scottish	PI/CG	PI/CG
Greyhound	PI/CG	PI/CG
Ibizan Hound	CG	CG
Irish Wolfhound	PI/CG	PI/CG
Italian Greyhound	PI/CG	PI/CG
Pharaoh Hound	PI/CG	PI/CG
Rhodesian Ridgeback	PI/CG	PI/CG
Saluki	PI/CG	PI/CG
Whippet	PI	PI

***** SIGNED WAIVER MUST ACCOMPANY ENTRY FORM OR ENTRY WILL BE DENIED *****

MANITOBA GAZEHOUND ASSOCIATION WAIVER

RELEASE OF LIABILITY, WAIVER OF CLAIMS, ASSUMPTION OF RISK AND INDEMNITY AGREEMENT

PLEASE READ THIS DOCUMENT CAREFULLY

BY SIGNING THIS DOCUMENT YOU WILL WAIVE CERTAIN LEGAL RIGHTS, INCLUDING THE RIGHT TO SUE OR CLAIM COMPENSATION FOLLOWING AN ACCIDENT.

I _____ (PRINT NAME) certify that I am the actual owner of this/these dog(s) _____ (PRINT NAMES OF DOG(S) or that I am the duly authorized agent/handler of the actual owner whose name I have entered above.

In consideration of acceptance of the entry and the opportunity to have the dog judged and to win ribbons or prizes at the **LURE COURSE** events to be held on **MAY 11th and/or MAY 12th, 2019**, I agree:

1. To hold the Manitoba Gazehound Association including their members, directors, officers and employees (collective defined as the "MGA"), as well as the owner and lessor of the real property on which the event is held, harmless from any claim for loss or injury which may be alleged to have been caused directly or indirectly to any person or thing by the act of myself or my dog(s) while in or about the event premises or grounds near the entrance thereto and I assume all responsibility and liability for any such claim;
2. To hold the MGA harmless from any claim for loss of this dog by disappearance, theft, death or otherwise and from any claim for damage or injury, even if such loss or damage/injury was caused or alleged to be caused by negligence of the MGA or by the negligence of any other person for any other cause(s).
3. Assume the sole responsibility for and agree to indemnify, defend and save the MGA harmless from any and all loss and expense, including legal fees, by reason of the liability imposed by law upon the MGA for damage because of bodily injuries, including death at any time resulting therefrom, sustained by any person(s), including myself, or on account of damage to property, arising out of or in consequence of my participation in the event, however such injuries, death or property damage may be caused and whether or not the same may have been caused or may alleged to have been caused by the negligence of the MGA or any other person(s);
4. That any cause of action, controversy or claim arising out of or related to the attendance and/or participation at this event between the MGA and myself or as to the construction, interpretation and effect of this waiver shall be settled by arbitration in the province of Manitoba, Canada and
5. That the MGA has the right to refuse this entry for cause, which the MGA will deem sufficient.

PRINT NAME OF HANDLER/AGENT

DATE

SIGNATURE(S) OF OWNER/HANDLER/AGENT



**Official Entry Form
LURE COURSE TRIALS**

May 11th and May 12th 2019

MANITOBA GAZEHOUND ASSOCIATION

**Mail entries to: Manitoba Gazehound Association
c/o Candace Cook, Box 12 Group 553 RR5 Winnipeg, MB, R2C 2Z2**

Saturday, May 11, 2019 _____

Sunday, May 12, 2019 _____

Entry \$ _____ **Listing \$** _____ **Total \$** _____

Breed: _____

Call Name: _____

Registered Name of Dog:

Date of Birth: _____ **Place of Birth: Canada** _____ **Elsewhere** _____

CKC Reg. No. _____ **Listed: Yes** _____ **No** _____

CKC ERN No. _____ **CKC PEN No.** _____

CKC MCN No. _____

Breeder(s)

Sire:

Dam:

Registered Owner(s):

Owner's Address:

City

Province

Postal Code

I certify that I am the registered owner(s) of the dog or that I am the authorized agent of the owner(s) whose name(s) I have entered above and accept full responsibility for all statements made in this entry. In consideration of this entry, I (we) agree to be bound by the rules and regulations of the Canadian Kennel Club and by any additional rules and regulations appearing in the Premium List.

Signature of Owner (Agent)

Phone Number

Email address

PLEASE PRINT CLEARLY

Lure Course 685 yards

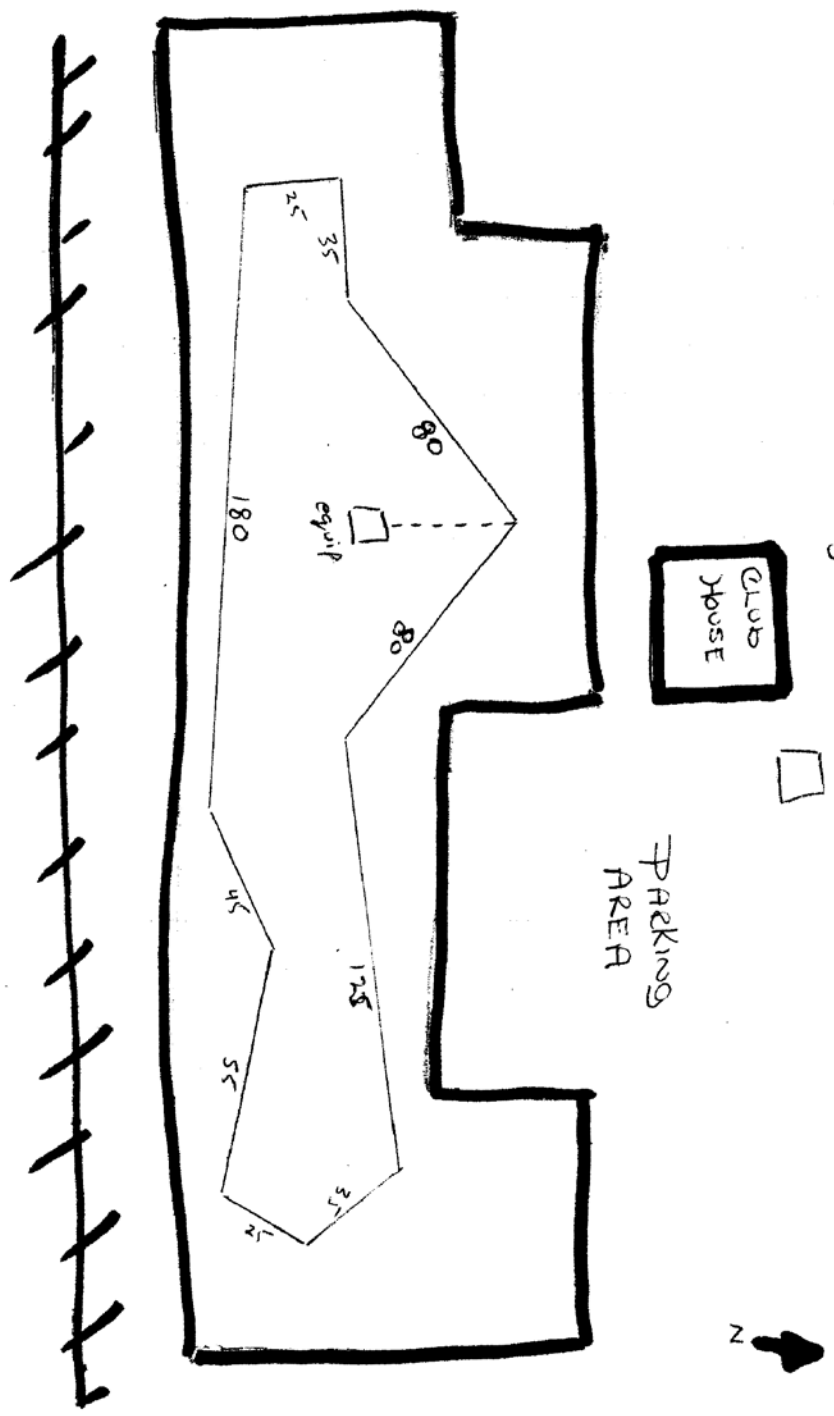

Manitoba Gazettehound Association
Lure Course - May 11, 2019

Lure Course 660 yards

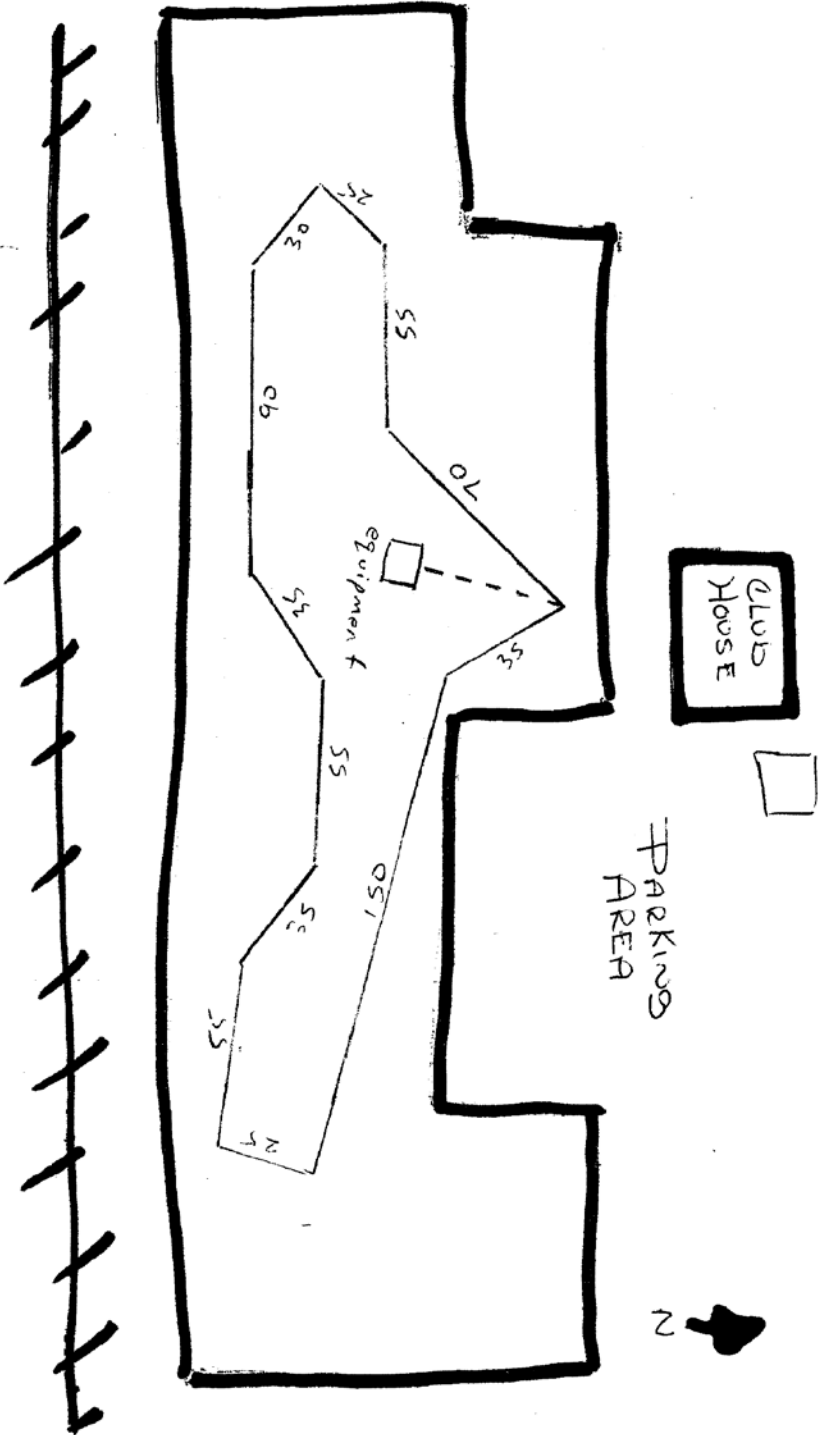

Mantoba Gazerhood Association
Lure Course - May 12, 2019