

Official Premium List



ALBERTA LURE COURSING ASSOCIATION

Saturday September 4, 2021
Lure Field Trial
&
Field Trial Conformation Show

Sunday September 5, 2021
Lure Field Trial

(Outdoors)

These Events Held Under the Rules of the Canadian Kennel Club

To Be Held At:
Bremner House

53452 Rge Rd 225, Sherwood Park, AB T8A 4V3

Co-Ordinates: Lat 53 deg, 36', 30.0" N Long —113 deg, 13', 29.0" W

Mail ALL Entries To:
Miriam Woestenburg,
12927-78 St. Edmonton, Ab T5C 1G6
(780) 456-2866

E-mail: minidragon@shaw.ca

Secure on-line entry service available at
www.dogshow.ca (VISA, Mastercard, American Express & Interac)

Entries Limited to 75 in Regular Stake Each Day

Conformation and Field Trial Early Bird Entry Closes Monday August 30, 2021

Post Entry Closes: Saturday 8:30 am Official Classes

Sunday 8:30 am Official Classes
10:00 am Puppy, Veteran

Roll Call: Saturday 9:00 am Official Classes

Sunday 9:00 am Official Classes
Puppy, Veteran – Immediately following preliminary courses



ROLL CALL TIMES AND RUNNING ORDERS:

We are offering a Rolling inspection between the time you arrive and Roll Call.

Roll Call for Official Classes: 9:00 a.m.

Roll Call for Puppy & Veteran Stakes (Sunday): After Preliminary runs

Field Trial Conformation Show will begin within ½ hour of field trial ribbon ceremony.

Puppy Stake & Veterans Stakes **Sunday only:** will be run after preliminary runs

Best in Field will be run on Sunday only. Best of Breed and Mixed Stake winners from both Saturday & Sunday are eligible for Best In Field.

Run Order Both Days: To be announced at Roll Call.

ENTRY FEES:

FIELD TRIAL CONFORMATION SHOWS

Entry (entries close Monday, August 30th) \$25.00

Hound must earn a qualifying score in the field trial to participate in the show

LURE COURSING FIELD TRIALS

First hound (early bird entries close Monday, August 30th) \$22.00

Additional hound same household \$20.00

*TCN (Temporary Competition Number) Fee per event per dog \$10.50

Post entries (Lure trials only) \$35.00

Puppy Stake, Veteran Stake (Sunday) \$ 5.00

Breeder Stake, Kennel Stake, Club Stake (Sunday) \$ 5.00

PIG ROAST ****Must be reserved by Monday, August 30th ****

Adult \$20.00

Under 12 years \$ 8.00

*TCN – Temporary Competition Number **MUST** be obtained from the CKC prior to entering any CKC event. TCN's will replace the previous system of entering events with dogs as 'listed' and will allow dogs to temporarily participate in CKC events while they pursue permanent registration or an Event Registration Number (ERN).

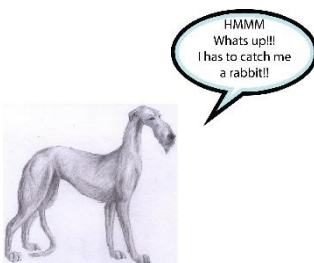

Dog Show.ca
ENTER ONLINE @ WWW.DOGSHOW.CA



A service charge of 10% will be assessed. This includes entries sent online or post using a credit card or interac for payment.

LURE TRIAL OFFICIAL STAKES:

Open Stake - for all eligible hounds, including Field Champions.

Mixed Stake - if there are multiple breeds with entries of three or less, upon agreement of all owners, they will be combined in a Mixed stake.

CONFORMATION SHOW CLASSES:

Juvenile – for dogs 12 to 18 months

Bred by Exhibitor – for dogs owned and handled in the ring by the breeder

Open - for all eligible lure coursing breeds

Specials Only - for Canadian Champions only

Altered – for dogs that have been spayed or neutered by veterinary procedure.

NOTES:

Hounds must be entered in the Open or Mixed Stake of the lure trial to participate in the Field Trial Conformation Show. As per CKC rule 1.2.2 Only those hounds that have competed in the Open or Mixed Stake and obtained a qualifying score may compete in the conformation show.

LURE TRIAL UNOFFICIAL CLASSES:

Best in Field – Sunday - Best of Breed and Mixed Stake winners from both days are eligible to participate

Puppy Stake (6-9, 9-12, 12-18 months) Sunday after completion of preliminary runs – dogs are run singly over a shortened course.

Veteran Stake (Unofficial) – (dogs 7 years and older) Sunday after completion of **Puppy Stake** – dogs are run singly over a shortened course.

Kennel Stake, Breeder Stake - Sunday - 2 dogs, determined by score adjusted for judges' average.

Club Stake - Sunday - 3 dogs, top 2 scores adjusted for judges' average.

Combinations for Kennel, Breeder & Club Stake to be named before first course runs on Sunday

COURSING JUDGES:

Jennifer Council	Blackie, AB	JC
Pat Ingram	Rocky View County AB	PI
Lynda Webster	Edmonton, AB	LW

LURE COURSING JUDGES & ASSIGNMENT * PROVISIONAL

Breeds	Saturday September 4	Sunday September 5
Afghan Hound	JC, LW	JC, PI
Azawakh Hound	LW, PI	LW, PI
Basenji	LW, PI	LW, PI
Borzoi	JC, PI	JC, LW
Deerhound (Scottish)	LW, PI	LW, PI
Greyhound	JC, LW	JC, PI
Ibizan Hound	JC, LW	JC, LW
Irish Wolfhound	*JC, PI	*JC, PI
Italian Greyhound	LW, PI	LW, PI
Pharaoh Hound	*JC, PI	*JC, LW
Rhodesian Ridgebacks	LW, PI	LW, PI
Saluki	JC, PI	JC, PI
Whippet	LW, PI	LW, PI
Mixed Stakes	TBA	TBA

Official Vet for the event is PulseVet 780-570-9999

Our Judges

Jennifer Council Tarrango Reg'd Whippets



Jennifer Council has been involved in training, showing and breeding dogs since 1999. Jenn started in Siberian Husky's and competed in agility and conformation with her first few, she also enjoyed skijoring and sledding and spent a lot of time playing in the snow with her pack. In 2007 Jenn was invited to a lure coursing trial to do some photography and her life was never quite the same. That weekend she went home with her first whippet "T" who went on to become MBIF Weerob There's Hemi In T Fch. It didn't take long for whippets to take over her house. Jenn has now been breeding whippets under the prefix Tarrango Reg'd since her first litter in 2009. Her and her guy, Jason Johnstone live in southern rural Alberta where they share their home with the whippets, a pride of barn/house cats, a small herd of horses and a flock of quail. Jenn continues to show her dogs, though she has not had anything running for a while. Hopefully she will have something to run in the near future, though at the moment there are a couple of co-owned dogs out there to keep the Tarrango name on the field.

Pat Ingram



What happens when you reply to a newspaper ad about lure coursing? You celebrate 43 years in the sport. Bruce and I got our first Borzoi in 1977 and answered an ad posted by the Foothills Gazehound Club in 1978 and have been involved ever since. I acted as the club's first Field Trial Secretary in 1980 having never attended a trial before.

I started judging in 1985 when lure coursing was done under the Canadian Sighthound Field Association. My first apprenticeships were when ALCA ran a three-day trial Thanksgiving weekend. I started out apprenticing everything, but as the weather deteriorated by day three it was only the breeds with the biggest entries, Greyhounds, Irish Wolfhounds and Whippets. I'm a pack rat and still have all the paperwork from my early apprenticeships and provisional assignments. I persevered and achieved All breed status in July of 1988. As a Lure coursing Judge, I also judge Chase Ability events.

Throughout the years we have bred/owned some of the top lure coursing Borzoi in Canada. The three Deerhounds that we have owned showed little or no interest in the "wabbit". We currently are owned by two Ibizan Hounds both of whom have done well in the coursing field. My Canadian judging assignments have taken me from Thunder Bay (when there was a club out there) to Vancouver Island. I have also judged both American Sighthound Field Association and American Kennel Club field trials in Montana, Washington, and California.

Looking forward to seeing some great runs. Tally Ho!!



Lynda Webster



I've been involved with dogs since before I knew who I was. However, since 1979 I have been involved with Greyhounds. These dogs lead me astray to many parts of the world. We took part in the show ring, racing, oval track racing, open field coursing and Lure Coursing. Nearly all my dogs finished their lure coursing championships. Ch. Windwood Count of Monte Cristo FCHX, Ch. Terrible Tinker FCHX, CC (open field coursing champion), just to name my starter greyhounds. Few will remember these dogs today but they are in the history books – somewhere. I was very lucky with my hounds as they were well accepted in the show ring as well as being good performers in the open field, on the race track and of course, lure coursing. I still have the memories of all my greyhounds and the journey we took together, from Canada, to the US, to England, my dogs and I led a life of adventure. ALCA has been my home club since 1979 when I first learned about Lure Coursing. Due to a lot of whippets and not a lot of judges around to judge them (most owned whippets and as you know, you can't judge your own dog) I started on the judging journey in 1984. The sport needed judges then and I think we still need talented and dedicated new judges today. I would strongly encourage more people to take on this fun and challenging task. Remember, you get the best view of all! Today, I no longer have greyhounds but I am still interested in the running dog, and it is still fun to judge all the dogs presented on the field today.

Lee Anne Bateman

CKC Licensed All-Breed Judge



Thank you for the opportunity to introduce myself.

My main breeds are Samoyed, Shih Tzu and Japanese Chin. I bred **Samoyed** under the *Snowghost* prefix for over 30 years and have proudly showed many of them to #1 Samoyed in Canada. My **Shih Tzu** were also bred under the *Snowghost* prefix. I now breed **Japanese Chin**, with partners, under the prefix *Xclusive Chins*.

Other breeds that I have lived with, owned and shown include Greyhound, Pomeranian, Siberian Husky, Basset Hounds and German Shepherd Dogs. Other activities I've enjoyed with my dogs over the years include Obedience, Sled Racing, Lure Coursing, and Tracking.

I have been judging dogs since 1999, and over the years, I have judged in every province across Canada, and have been privileged to have judged at many international events.

By profession, I am an artist and writer. Judging dogs is a passion that I am always happy to indulge.

For more information about CKC Show Rules and Regulations:

<https://www.ckc.ca/en/Files/Forms/Shows-Trials/Event-Rules-Regulations/Conformation-Show-Rules-and-Regulations.aspx>

PRIZES AND AWARDS:

Conformation Show

Rosette & prize: Best of Breed, Best Opposite Sex, Best of Winners
 Best in Field Trial Conformation Show,
 Best Altered in Field Trial Conformation Show
 Rosette: Select, Winners, Reserve Winners
 Ribbon: all class placements

Field Trial

Rosette & prize: Best in Field, Best of Breed, 1st in Mixed
 Rosette: 2nd to NBQ, Best Puppy in Field, Best Veteran in Field,
 Ribbon: 1st to NBQ in each puppy class
 Ribbon: for **qualifying score** earned by a hound which has not previously earned the Novice
 Courser title. **Please notify Field Trial Secretary if you hound qualifies.**

New Title Rosettes

ALCA is pleased to offer a Club Rosette for each hound completing a coursing or conformation
 title at this event. **Please notify Field Trial Secretary if your hound has completed a new title.**

ANDARE AGGREGATE AWARD

ALCA is pleased to offer a rosette and prize to the hound with the highest aggregate score for trial and
 show. The winner of this award will be determined by adding each hound's coursing score to a score
 assigned by the conformation judge. In the event of a tie, the higher coursing score will determine the
 winner. The winning hound's name will be engraved on a plaque on the Andare Perpetual Trophy.

2021 COURSING AGGREGATE AWARD

**DUE TO THE COVID-19 PANDEMIC HIATUS
 THE ALCA AGGREGATE AWARD WILL NOT BE OFFERED FOR
 THE 2021 COURSING SEASON**

FIELD TRIAL COMMITTEE AND OFFICIALS		ALBERTA LURE COURSING ASSOCIATION 2020 EXECUTIVE		CONFORMATION COMMITTEE AND OFFICIALS	
Field Trial Chair	Ed Molloy	President	Bobbi Westman	Show Chairman	Cindy Kremer
Field Trial Committee:	Ed Molloy Cherie Hunchak Cindy Kremer Piet Woestenburg Ivy Molloy	Vice President	Piet Woestenburg	Show Committee	Cherie Hunchak Bobbi Westman Ed Molloy
Field Clerk Nevidka Algu	Ivy Molloy	Secretary	Cindy Kremer	Chief Ring Steward	Pat Hagen
Field Trial Secretary	Miriam Woestenburg	Treasurer	Ivy Molloy	Show Secretary	Miriam Woestenburg
Lure Operators	Cherie Hunchak Ed Molloy				
Hunt Master	Nevidka Algu Piet Woestenburg				
COMPLAINTS COMMITTEE: Ed Molloy, Cherie Hunchak, Cindy Kremer, Miriam Woestenburg, Piet Woestenburg				Ed Molloy, Cherie Hunchak, Cindy Kremer, Bobbi Westman	

ATTENTION:

It shall be the obligation of the trial-giving club to see that a judge, club official, volunteers
 or any participant at the CKC any infringement of this regulation and the Discipline
 Committee shall have the authority to take such action as it deems fit on the receipt of a
 report indicating that this has occurred.



Saturday

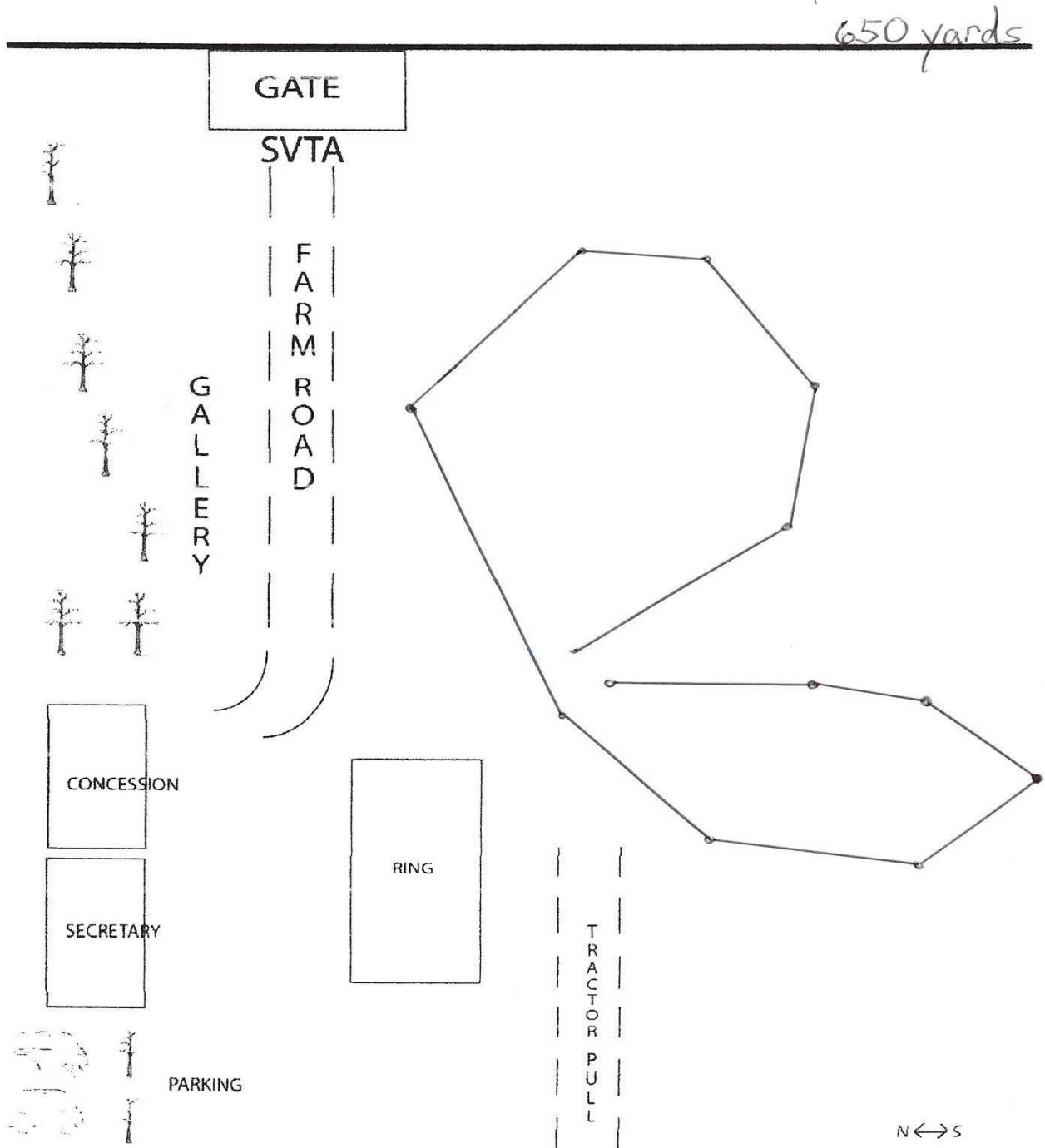

Sunday

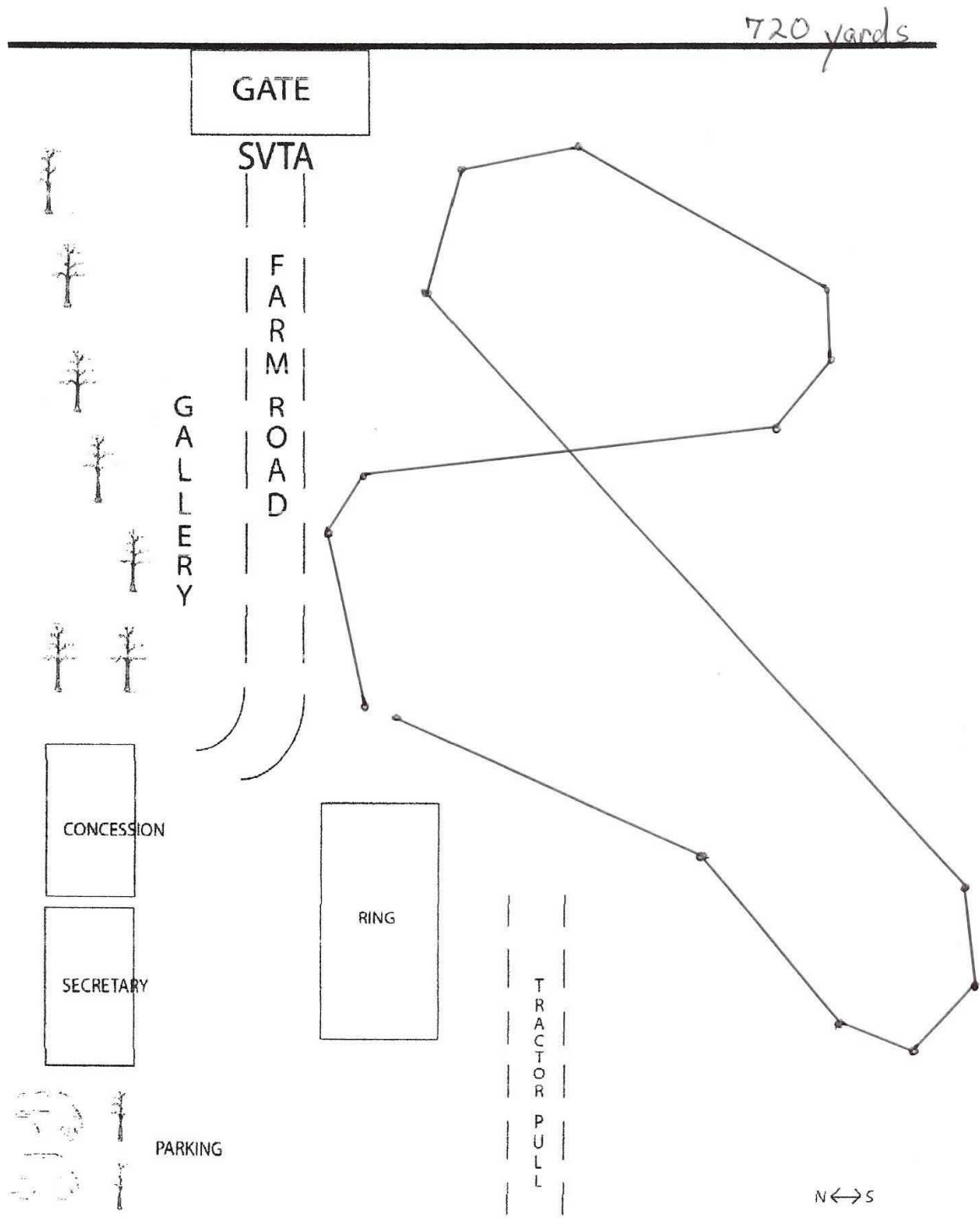



WE'S HAVING A PIG ROAST!!

(YUM YUM!!!!)

JOIN US ON SEPTMEBER 4TH FOR A PIG ROAST AT NOON!! ADULTS \$20.00, KIDS 12 AND UNDER \$8.00 PLEASE RESERVE BY AUGUST 30 PLEASE CONTACT MIRIAM WOESTENBURG AT MINIDRAGON@SHAW.CA



ADULTS \$20 X _____

KIDS \$8 X _____

TOTAL \$ _____

INCLUDES ALL THE FIXINGS
AND DESSERTS!!!!!!!!!!!!

CANADIAN KENNEL CLUB OFFICIALS:

THE CANADIAN KENNEL CLUB EXECUTIVE DIRECTOR

Mr. Jeff Cornett, 200 Ronson Drive, Suite 400, Etobicoke, ON, M9W 5Z9 (416) 675-5511

THE CANADIAN KENNEL CLUB DIRECTOR FOR ALBERTA

Lee Ann Bateman, Edmonton AB (780) 901-6754 Email: zone10director@ckc.ca

THE CANADIAN KENNEL CLUB DOG SHOW REPRESENTATIVE FOR ALBERTA (CONFORMATION)

Tina Gaudet Email: gtguadet@shaw.ca

ALBERTA LURE COURSING REPRESENTATIVE

Ed Molloy Email: andare@syban.net

DIRECTIONS TO THE FIELD

This field is northeast of Sherwood Park. Shopping, gas & coffee are less than **10** min away.

Entrance to field has SVTA in big letters over the gate.

From South: Hwy 21 north to Township Road 534 (first north of Hwy 16) Turn right/East on Township Road 534 to Range Road 225 (approx. 2 km) Turn left/north on Range Road 225. Field is 1/2 km north of Twp Rd 534 on left.

From East: Hwy 16 West to Range Road 225 Turn right/north on Range Road 225. Field is approx. 4 km north of Hwy 16 on left.

From West: Hwy 16 East through Sherwood park to Range Road 225 Turn left/north on Range Road 225. Field is approx. 4 km north of Hwy 26 on left.

EQUIPMENT AND FIELD CONDITIONS

This field is a mown hay field, flat on the west side, sloping towards the road. An electric drag will be used.

CONDITIONS AND INFORMATION

- Rolling inspection — check in for inspection as you arrive, with your dog(s). It is your responsibility to take your dog for inspection prior to roll call.
- Lure Coursing is a strenuous athletic pursuit that requires your dog to be in excellent condition. Your dog relies on you to ensure this.
- All hounds will be run in trios or braces, twice, unless excused, dismissed or disqualified.
- Hounds not present at roll call will be scratched, and their entry fee will NOT be refunded. No exceptions.
- All handlers MUST use a slip lead when releasing their hounds.
- Hounds may wear muzzles and/or catch collars at the owner/agent's discretion.
- Bitches in season and lame hounds will be excused and will have their entry fee returned if notice is given to the secretary **prior** to roll call.
- The Chair may excuse any hound from competition for any reason deemed justifiable.
- A \$10.00 fine, payable to ALCA, will be levied for any hound loose on the field at any time between Roll Call and the completion of Best in Field Trial Conformation Show.
- There is limited shade and no water available, so come PREPARED.
- There will be limited overnight camping. Please contact Ed Molloy to reserve your spot. (780) 922-5218.
- ALCA, its agents, members, representatives, volunteers, etc., assume no responsibility for any loss, damage or injury sustained by exhibitors, handlers, or to any of their dogs or property and further assumes no responsibility for injury to children or spectators.
- All rights to televise, videotape, advertise, photograph, promote or otherwise exploit this event are vested in the club, or in persons to whom assignments of such rights have been made in writing by the club. All persons and animals attending these shows grant the club the right to use their likeness and voice in any matter without further consent.

ALL RULES GOVERNING THESE EVENTS ARE AVAILABLE ON LINE FROM THE CANADIAN KENNEL CLUB

<https://www.ckc.ca/en/Files/Forms/Shows-Trials/Event-Rules-Regulations/Lure-Coursing-Field-Trial-Rules-and-Regulations.aspx>



Official Canadian Kennel Club Entry Form
Alberta Lure Coursing Association
2 LURE FIELD TRIALS
and 1 FIELD TRIAL CONFORMATION SHOW
 September 4 & 5, 2021



ENTER IN THE FOLLOWING CLASSES: One entry form per hound

CONFORMATION: Pre entries only MALE FEMALE
 Juvenile 12-18 months Open Bred by Exhibitor Specials only Altered
(Dog must be entered in lure trial to enter show)

<input type="checkbox"/> Field Trial Conformation Show: Saturday <input type="checkbox"/>	\$ 25.00 =
<input type="checkbox"/> Lure Field Trial: Saturday <input type="checkbox"/>	\$ 22.00 =
Sunday <input type="checkbox"/>	\$ 22.00 =
Each additional dog same household	\$ 20.00 =
<input type="checkbox"/> Post Entry	\$ 35.00
<input type="checkbox"/> TCN (Temporary Competition Number) Per event, per dog	\$ 10.50
<input type="checkbox"/> Juvenile/Puppy Stake, Veteran Stake, Breeder Stake, Kennel Stake, Club Stake	\$ 5.00 =
<input type="checkbox"/> PIG ROAST: _____Adult \$20_____ Children \$8	\$ =
Total \$	

Enclose \$_____for Entry Fees \$_____Listing Fees \$_____Other \$_____
 Visa Mastercard American Express
 Card No. _____ Expiry _____/_____/_____

CARDHOLDER NAME (PLEASE PRINT):

Breed:	Call Name:	<input type="checkbox"/> Male <input type="checkbox"/> Female
--------	------------	---

Registered Name of Hound:

Check one & enter Number here:	Is this dog's first trial? Yes <input type="checkbox"/> No <input type="checkbox"/> If Yes, bring or attach Hound Certification Please separate my hounds <input type="checkbox"/>
--------------------------------	--

<input type="checkbox"/> CKC Reg. No.	Date of birth D_____M_____Y_____	Is this a puppy? Yes <input type="checkbox"/> No <input type="checkbox"/>
<input type="checkbox"/> CKC ERN No.		
<input type="checkbox"/> CKC Misc.Cert.No.	Place of Birth:	Owner's CKC Membership No.
<input type="checkbox"/> CKC PEN No	Canada <input type="checkbox"/>	
<input type="checkbox"/> TCN	Elsewhere <input type="checkbox"/>	

Breeder(s): _____

Sire: _____

Dam: _____

Reg'd Owner(s): _____ Email: _____

Owner's Address: _____

City:	Prov:	Postal Code:
-------	-------	--------------

Name of Owner's Agent (if any) at the Trial	Email
---	-------

City	Prov	Postal Code
------	------	-------------

I CERTIFY that I am the registered owner(s) of the dog or that I am the authorized agent of the owner(s) whose name(s) I have entered above and accept full responsibility for all statements made in this entry. I CERTIFY that one of the owners has the CKC membership number listed above. In consideration of the acceptance of this entry, I (we) agree to be bound by the rules and regulations of the Canadian Kennel Club and by any additional rules and regulations appearing in the premium list.

*****IDs will not be mailed – please supply email address for entry confirmation*****

Signature of Owner or Agent _____ Phone _____



Alberta Lure Coursing Association - Accidental Waiver & Release of Liability Form

In consideration of the acceptance of this Alberta Lure Coursing Association (ALCA) membership and or individual practice/fun(s) runs, the holding of this event(s), official trials, and the opportunity to have the canine(s) run, I agree to hold the organizing committee, the organization which it represents, including its members, officers and directors, volunteers, owners of the premises upon which the event(s) is held and their employees, hold harmless from any claim for loss or injury which may be alleged to have been caused directly or indirectly to any person or thing by the act of this dog while in or upon the event premises, or grounds, or near any entrance thereto, and I personally assume all responsibility and liability for any such claim.

I further agree to hold the aforementioned parties harmless from any claim for loss of this dog by disappearance, theft, death, or otherwise, and from any claim for damage or injury, to be caused or alleged to be caused by negligence of the parties aforementioned, or by the negligence of any other person, or any other cause or causes.

I hereby assume the sole responsibility for and agree to indemnify the aforementioned parties hold harmless from any and all loss and expenses (including legal fees) by reason of the liability imposed by law upon any of the aforementioned parties for damage because of bodily injuries, including death at any time resulting there from sustained by any person or persons, including myself and my guest or on account of damage to property, arising out of or in consequence of my participation in this event, howsoever such injuries, death or damage to property may be caused or may have alleged to have been caused by negligence of the aforementioned parties or any of their employees or agents, or any other person.

I hereby consent to receive medical treatment, which may be deemed advisable in the event of injury, accident, and/or illness during this activity.

I understand while participating in this activity, I or my canine(s) may be photographed. I agree to allow my photo, video, or film likeness to be used for any legitimate purpose by the activity holders, producers, sponsors, organizers, and assigns.

The Accident Waiver and Release of Liability Form shall be construed broadly to provide a release and waiver to the maximum extent permissible under applicable law.

Name: _____ Phone: _____ Email _____

Name of Canine(s)

#1 _____ Any Canine Health Related Issues: _____

#2 _____ Any Canine Health Related Issues: _____

#3 _____ Any Canine Health Related Issues: _____

I certify that I have read this document and I fully understand its content. I am aware that this is a release of Liability and a contract and I sign it of my own free will.

Signature: _____ Date: _____ 2021

Signature of parent/guardian is required for children under 18 years