



WINTER CLASSIC

January 25 - 27, 2019

at



Official Premium List

Three All Breed Championship Shows

Entry Limited to 475 regular class entries/day

(count excludes Veteran & Baby Puppy Classes)

Three Rally Obedience Trials

Three Obedience Trials

SPONSORED BY



Eukanuba

Post-Closing entries for Performance (Where space allows)

Mixed or unrecognized breeds will be permitted to compete in Performance Events

OTHER EVENTS

Conformation Fun Match – Thursday evening

Obedience Fun Match – Thursday evening

Rally Obedience Fun – Thursday evening

Two Obedience Sanction Matches – Friday evening

Hosted by the Dalmatian Club of Canada and the Western Canada Dalmatian Club

Junior Showmanship Competition – Saturday and Sunday

Scent Hurdle Racing – Saturday after Best in Show (Entry limited to 7 teams)

ASSOCIATED SPECIALTY SHOW AND SWEEPSTAKES

Alberta Shetland Sheepdog and Collie Association

FREE PARKING!

RESERVED BENCHING AND POWER AVAILABLE

Pre-ordered only – see inside pages 13-14 for details



Complimentary Chili and a Bun



On Thursday evening 5pm

ENTRIES CLOSE 10:00 P.M. MST, Monday January 7, 2019

Spruce Meadows Equi-Plex

Spruce Meadows, 18011 Spruce Meadows Way SW Calgary, AB, Canada

Permission has been granted by the Canadian Kennel Club for the holding of these events under

Canadian Kennel Club rules and regulations.

(UNBENCHED)

(INDOORS)

(UNEXAMINED)

ALBERTA KENNEL CLUB

Club Officers:

President: Wendy Hamilton-Petkau
Vice-President: Marian Heinze
Secretary: Janna LaBerge

Show Committee:

Show Chairperson: Linda Kool
Chief Ring Steward: Charlene Maines
Obedience Chairperson: Maureen O'Neill
Obedience Chief Ring Steward: Avril Tatterson (Jan 25, 2019)
Laurie Albright (Jan 26,27, 2019)
Rally-O Chairperson: Maureen O'Neill
Rally-O Chief Ring Steward: Avril Tatterson
Booth Chairperson: Marni Kueber

Complaints Committee:

Show Chairperson
Show Superintendent
Any member of the Show Committee

Show Secretary

VGI Show Services Events

243 Mahogany Landing S.E. E-mail: events@verwey.ca
Calgary, AB T3M 1X4 Phone: (403) 803-8590

CLOSING Monday January 7, 2019 AT 10PM (MST)

SHOW SUPERINTENDENT: Wendy Hamilton-Petkau mail@auburnmist.com Box 72042, D167, R.P.O.Glenmore Landing Calgary, AB T2V 5H9 Phone: 403 949-2094	CANADIAN KENNEL CLUB, EXECUTIVE DIRECTOR: Lance Novak 200 Ronson Drive, Suite 400 Etobicoke, ON M9W 5Z9 Phone: (416) 675-5511 Fax: (416) 675-6506
CANADIAN KENNEL CLUB, DIRECTOR FOR ALBERTA: Sharon Derrick sderrick@shaw.ca	CANADIAN KENNEL CLUB DOG SHOW REPRESENTATIVE FOR ALBERTA: Tina Gaudet gtgaudet@shaw.ca
CANADIAN KENNEL CLUB OBEDIENCE & RALLY-OBEDIENCE REPRESENTATIVE FOR ALBERTA: Lionel Whittaker Lionel.Whittaker@gmail.com	CANADIAN KENNEL CLUB, JUNIOR KENNEL CLUB REPRESENTATIVE FOR ALBERTA: Shannon Scheer mail@shannonscheer.ca
24Hr. Full Service Veterinarian (close to show site): Fish Creek 24 Hr. Veterinary Pet Hospital 15311 Bannister Road S.E. Calgary, AB T2X 1Z3 Phone: (403) 873-1700	OFFICIAL PHOTOGRAPHER: Cathy French Photography Box 3118, Sherwood Park, AB T8H 2T1 Email: cfrench_photo@shaw.ca Phone: (780) 416-6096

Conformation Judges:

ANTHONY D DINARDO	20 PEASLEE HILL, WEST HARTFORD CT USA
ANIK PRIMEAU	715 DE TOURAINE, SAINTE JULIE QC
PATRICIA J TAYLOR	311 RODNEY STREET, HEADINGLEY MB
MARY B. WHITE	5521 RIVER STYX RD., MEDINA OH USA

Obedience / Rally-Obedience Judges:

LISBETH J BOOTH	10236-104 STREET, WESTLOCK AB
DIANA E MACKENZIE	119 BUCKINGHAM DR., HAMILTON ON

Judging Assignments – Group and Best in Show

General Specials	Friday	Saturday	Sunday
Best In Show	Patricia Taylor	Mary White	Anthony DiNardo
Reserve Best In Show	Patricia Taylor	Mary White	Anthony DiNardo
Best Puppy In Show	Patricia Taylor	Mary White	Anthony DiNardo
Best Baby Puppy in Show	Patricia Taylor	Mary White	Anthony DiNardo
Best Veteran in Show	Patricia Taylor	Mary White	Anthony DiNardo
Group 1 Sporting	Anthony DiNardo	Patricia Taylor	Mary White
Group 2 Hounds	Mary White	Anthony DiNardo	Patricia Taylor
Group 3 Working	Patricia Taylor	Mary White	Anthony DiNardo
Group 4 Terriers	Anthony DiNardo	Patricia Taylor	Mary White
Group 5 Toys	Mary White	Anthony DiNardo	*Patricia Taylor / Anik Primeau
Group 6 Non-Sporting	Patricia Taylor	Mary White	Anthony DiNardo
Group 7 Herding	Mary White	Anik Primeau	Patricia Taylor

Judging Assignments – Obedience and Rally-Obedience

	Friday	Saturday	Sunday
Obedience	Lisbeth J Booth	Diana E MacKenzie	Lisbeth J Booth
Rally-Obedience	Diana E MacKenzie	Lisbeth J Booth	Diana E MacKenzie

Sunday

***Group 5 – Patricia Taylor** – Group and Affenpinscher to Maltese; **Anik Primeau** – Miniature Pinscher to Yorkshire Terrier

ENTER ONLINE @ DOGSHOW.CA

ENTER ONLINE AND WIN A TRIP* FOR TWO TO
THE 2019 CRUFTS IN BIRMINGHAM, ENGLAND

Prize valued at \$4,500!









A service charge of 10% will be assessed. This includes entries sent online, by fax or post using a credit card or Interac for payment.

* No purchase required. Full contest details available at www.dogshow.ca/en/contest

Entry Fees (GST included)	GST# R123176257
Entry fee for Conformation / Obedience / Rally Obedience Classes	\$ 32.00
Entry fee for Conformation – same dog entered all three days	\$ 90.00
Entry fee for Obedience / Rally-Obedience - same dog entered all three days	\$ 90.00
Obedience SPECIAL – Same dog, same trial; entered in HB or 18B and Utility B	\$ 55.00
Rally SPECIAL – Same dog, same trial; entered in both Advanced B and Excellent B	\$ 55.00
Entry fee for Post-closing performance events (where space available)	\$ 40.00
Entry fee for Veteran Class	\$ 20.00
Entry fee for Baby Puppy Class (3 – 6 months)	\$ 18.00
Exhibition Only	\$ 15.00
Exhibition Only (3 - 6 months of age) these puppies may be entered, providing that the owner of the puppy also has entered another dog in one of the regular official classes.	\$ 5.00
LISTING FEE required for any dog without an individual CKC registration number, Performance Event Number (PEN) or CKC Event Registration (ERN), Miscellaneous Certificate Number (MCN)	\$ 10.50
*** CATALOGUE - PREPAID ONLY ***	\$ 13.00
A limited number of catalogues will be available for sale at the show	\$ 15.00

Each day is a separate show and the above fees apply per day, per show. (These fees include CKC recording fees + 5% G.S.T.)

Entries on-line must be made at:

www.DogShow.ca

Closing date Monday January 7, 2019 @ 10pm MST

DogShow.ca service fees 10% of total fees + GST will be charged on ALL credit card entries

whether you enter online, fax your entry or mail an entry and pay by credit card rather than by cheque

The Alberta Kennel Club will only accept on-line entries through the Dog Show.ca program.

Entries through any other professional entry system will not be accepted.

Cheques should be made payable to: ALBERTA KENNEL CLUB

(Cheques post-dated up until closing date of entries will be accepted.)

SHOW SECRETARY (to whom all mail entries must be sent):

VGI Show Services Events

243 Mahogany Landing S.E. E-mail: events@verwey.ca

Calgary, AB T3M 1X4 Phone: (403) 803-8590

All JUDGING SCHEDULES will be posted at:

www.dogshow.ca -- www.canuckdogs.com -- www.albertakennelclub.org

Dog Show.ca™

ENTER ONLINE @ WWW.DOGSHOW.CA

TOLL FREE FAX: 1-877-99-ENTRY (36879)

VISA MasterCard American Express Interac Apple Pay

A service charge of 10% will be assessed. This includes entries sent online, by fax or post using a credit card or interac for payment.

No Entry Will Be Accepted Without Payment in Full. Tendering of a dishonored cheque or declined credit card in payment of an entry fees shall be considered non-payment of entry fees and is an offense punishable by disciplinary action and cancellation of awards. (*Chapter 8.8, C.K.C. Dog Show Rules.*) **Any dishonored cheque or declined credit card(s) will be assessed a \$50.00 service charge.** The owner of a dog entered in this show is entirely responsible for any error in the entering of his dog, regardless of how, or by whom the entry was made

Attention Foreign Exhibitors: Please note that fees are due and payable in Canadian dollars. Due to consistently fluctuating currency rates, discounted cheques will not be accepted.

Personal cheques will be accepted, however, they are to be payable in Canadian funds. If you send a cheque in US funds, it must be made out for the full amount of the entry and no exchange will be refunded to the exhibitor.

Please do not mark cheques "Payable in Canadian Funds" or "At Par". They will not be cleared by the banks.

To simplify the process, we urge that you pay by credit card, bank drafts or money orders payable in Canadian funds. Your understanding and cooperation is appreciated.

Entries by any courier must be sent prepaid;

To comply with instructions issued by the Canadian Kennel Club, we will be unable to accept any entry reaching our Show Secretary after the closing time and date.

Please allow ample time for delays in the mail.

Exhibitors Please Note: An exhibitor has the right to withdraw an entry at any time up to the closing date and time as published in the premium list. This may be done by telephone but **written or electronic notification must be received by the show secretary not later than closing date and time.** If written or electronic notification is not received, the dog will remain entered in the show.

Entry fees will be refunded when a bitch entered in Rally/Obedience comes into season after the close of entries if a Veterinarian's Certificate (certifying that the bitch was in season within the 10 day period preceding the trial) is delivered to the Show Secretary **before the starting date and the time of the trial.** The Alberta Kennel Club will refund entry, recording and listing fees if the above conditions are met.

A 50% refund of entry fees only will be made for a bitch in season without a Veterinarian's certificate with written notification presented to the Show Secretary at least ONE HOUR before the start of the Trials. The bitch must be available to be examined by the Show Superintendent to verify she is in season.

There will be no refunds on duplicate entries or overpayments.

All JUDGING SCHEDULES will be posted at:

www.dogshow.ca -- www.canuckdogs.com -- www.albertakennelclub.org

A ramp will be available for use at the Judge's discretion.

Rosettes, Prizes & Awards

CONFORMATION		
Best in Show (each day)		Rosette & Royal Canin Gift
Reserve Best in Show (each day)		Rosette & Royal Canin Gift
Best Puppy in Show (each day)		Rosette & Royal Canin Gift
Best Veteran in Show (each day)		Rosette & Royal Canin Gift
Best Baby Puppy in Show		Rosette & Royal Canin Gift
First in Group (each day)		Rosette
Second in Group (each day)		Rosette
Third in Group (each day)		Rosette
Fourth in Group (each day)		Rosette
Best Puppy in Group (each day)		Rosette
Best Veteran in Group (each day)		Rosette
Best Baby Puppy in Group (each day)		Rosette
OBEDIENCE		
High in Trial	Rosette & Eukanuba Gift, plus a prize of \$20.00**	
High Aggregate	Rosette & Eukanuba Gift, plus a prize of \$50.00**	
First in Class		Rosette
RALLY OBEDIENCE		
High Aggregate	Rosette & Eukanuba Gift, plus a prize of \$75.00**	
First in Class (Saturday Jan 26, 2019)		Rosette & Eukanuba Gift
First in Class		Rosette

Additional Prizes & Supported Entries

Best in Show - Friday, January 25, 2019 – The Charlie Woodward Perpetual Memorial Trophy

will be awarded to the winner of Best in Show.

Possession of the memorial trophy remains with the Alberta Kennel Club. The winner will receive a keeper trophy.

Best in Show - Saturday, January 26, 2019 – The Joseph Fleming Perpetual Memorial Trophy

will be awarded to the winner of Best in Show.

Possession of this memorial trophy remains with the Alberta Kennel Club. The winner will receive a keeper trophy.

Best Puppy in Show - Sunday, January 27, 2019 – The Mary Driscoll Perpetual Memorial Trophy

will be awarded to the winner of Best Puppy in Show.

Possession of this memorial trophy remains with the Alberta Kennel Club. The winner will receive a keeper trophy

The Alberta Doberman Pinscher Club is pleased to consider the judging of their breed under **Mary White on Saturday January 26, 2019** at the Alberta Kennel Club Winter Classic as a booster for Doberman Pinschers. Prizes will be offered for: Best of Breed, Best of Opposite Sex, Best of Winners, Best Puppy In Breed, Winners Male, Winners Female, Select Dog, Select Bitch, Best Veteran, and Best Baby Puppy. For more information, please contact Alison Merrick by e-mail: mojavedobermans@gmail.com

The Alberta Doberman Pinscher Club is pleased to consider the judging of their breed under **Dr. Anthony DiNardo on Sunday January 27, 2019** at the Alberta Kennel Club Winter Classic as a booster for Doberman Pinschers. Prizes will be offered for: Best of Breed, Best of Opposite Sex, Best of Winners, Best Puppy In Breed, Winners Male, Winners Female, Select Dog, Select Bitch, Best Veteran, and Best Baby Puppy. For more information, please contact Alison Merrick by e-mail: mojavedobermans@gmail.com

****Obedience High Aggregate Award** – a prize of \$50.00 is sponsored by “Cathy French Photography”.

****Obedience High in Trial Award** – a prize of \$20.00 per daily HIT is sponsored by MsFizz

****Rally Obedience High Aggregate Award** – a prize of \$75.00 is sponsored by “Eskimom”

Dogs must be handled by the same person in all 3 trials to be eligible for the High Aggregate Score award. Qualifying Scores must be from the same class.

Best Veteran in Sporting Group – Wiley Creek Kennel offers a prize of \$25.00 in honor of Ch Wiley Creek Macon Dreams Come True RN (Seeker) and in memory of Wiley Creek Ben’s Blessing RN (Magic).

Oldest Veteran Competing in either Obedience or Rally Obedience– Wiley Creek Kennel offers prize of \$25.00 to honour all veteran dogs.

The Alberta Shetland Sheepdog and Collie Association is pleased to award a prize and a rosette to the Shetland Sheepdog, Rough Collie or Smooth Collie achieving the highest qualifying score in the Alberta Kennel Club all-breed obedience trials on Saturday, January 26, 2019. A prize is offered to ALL Sheltie, Rough & Smooth Collie participants.

The Alberta Shetland Sheepdog and Collie Association is pleased to award a prize and a rosette to the Shetland Sheepdog, Rough Collie or Smooth Collie achieving the highest qualifying score in the Alberta Kennel Club all-breed Rally Obedience trials on Saturday, January 26, 2019. In the case of a tie, the award will go to the fastest time. A prize is offered to ALL Sheltie, Rough & Smooth Collie participants.

Non-qualifying Obedience or Rally Obedience performance

The AKC is offering a \$5.00 coupon for each non-qualifying score in either Rally or Obedience. Each exhibitor must present their non-qualifying score sheet to the Trial Secretary to receive the Non-Qualifying Bonus Coupon. This coupon may be used to reduce the entry fee for any AKC event (expiry January 31, 2020). And yes, if you miss qualifying more than once, we WILL give you a coupon for each non-qualifying score!

ATTENTION – When you wish to redeem one of these coupons, you must quote the Coupon Code on each entry (paper or online) to get the discount. **Note – one coupon discount per entry please**

Junior Showmanship Competition

Saturday, January 26, 2019 and Sunday, January 27, 2019

Conformation Classes as follows:

Pee Wee, Junior Novice, Junior Open, Intermediate Novice, Intermediate Open, Senior Novice, Senior Open.

There will also be a Best Overall Junior Handler Competition for the 6 official classes

Saturday, January 27, 2019 before BIS, the Mary Driscoll Trophy is awarded to the Best Overall winner.

Held under CKC Rules and Regulations. Entry Fee: \$2.00 payable at show only

REGULAR CONFORMATION CLASSES	
Junior Puppy	A dog between 6 months and under 9 months on day of the show.
Senior Puppy	A dog between 6 months and under 12 months on day of the show.
12-18 Months	A dog between 12 months and under 18 months on day of the show.
Canadian Bred	A dog which is born in Canada
Bred By Exhibitor	A dog(s) owned and handled in the ring by the breeder. The handler must be the owner/co-owner AND breeder/co-breeder of the dog. The owner/breeder must handle the dog in this class, but need not handle the dog for further awards.
Open	For all dogs.
Specials Only	For dogs who are Canadian Champions only.
NON REGULAR CONFORMATION CLASSES	
Baby Puppy	A dog between 3 months and under 6 months of age on the day of the show. Winners of this class do not compete for points. The class is judged after breed judging, after Group Judging and prior to Best in Show Judging
Veterans	In this optional class for All Breed Shows, dogs must be 7 years of age and over on the day of the show. Dogs entered in this class may be spayed or neutered. The awards for this class are: Best Male Veteran and Best Female Veteran, Best Veteran in Breed, Best Veteran in Group, Best Veteran in Show. A Veteran awarded Best Veteran in Breed is not required to stay to compete for Best Veteran in Group. A Veteran awarded Best Veteran in Group is not required to stay to compete for Best Veteran in Show.
REGULAR OBEDIENCE CLASSES	
Pre-Novice	Please see the OBEDIENCE TRIAL & RALLY OBEDIENCE TRIAL RULES & REGULATIONS for complete information on classes
Novice A	
Novice B	
Novice C	
Novice Intermediate	
Open HA	The Open A Classes shall be for any dog of any recognized or listed breed, mixed breed or unrecognized breed which has earned the title of C.D. but has not earned the title of C.D.X. The handler of any dog in these classes must be the owner or a member of their immediate families. Only one dog per handler is allowed in these classes, and that person must handle the dog in all exercises. No dog may be entered in more than one (1) open class at any one trial. Any person who has trained or exhibited a dog that has earned a U.D. title may not handle a dog in these classes.
Open 18A	
Open HB	The Open B Classes shall be for any dog of any recognized or listed breed, mixed breed or unrecognized breed which has earned the title of C.D. Dogs which have earned the title of C.D.X. or any higher obedience titles may enter in the Open B Class. A dog may also be entered in the Utility Class in the same trial. Dogs in these classes may be handled by the owner or any other person. A person may enter or handle more than one dog in these classes. The same handler must handle each dog in all 7 exercises unless he has 2 or more dogs entered. In such case, they must have an additional handler for each extra dog when they are judged together in group exercise(s). No dog may be entered in more than one (1) open class at any one trial.
Open 18B	
Utility A	Please see the OBEDIENCE TRIAL & RALLY OBEDIENCE TRIAL RULES & REGULATIONS for complete information on classes
Utility B	
REGULAR RALLY OBEDIENCE CLASSES	
Novice A	Please see the OBEDIENCE TRIAL & RALLY OBEDIENCE TRIAL RULES & REGULATIONS for complete information on classes
Novice B	
Intermediate	
Advanced A	
Advanced B	
Excellent A	
Excellent B	
Master	This class will be for dogs that have earned the R.E. title. A dog completing the R.M. title may continue to compete in this class indefinitely. The owner or any other person may handle dogs in this class. A person may enter more than one dog in this class.
MIXED BREED OR UNRECOGNIZED BREED ENTRIES IN PERFORMANCE EVENTS	
Obedience Trials Rally Obedience Trials Agility Trials Scent Hurdle Racing	Amendments have been made to the Agility, Obedience and Rally Obedience Rules & Regulations such that mixed or unrecognized breed dogs are allowed to participate in the CKC Performance Events of Agility, Obedience and Rally Obedience Trials. The amendments are effective July 1, 2014. A <u>Canine Companion Number</u> allows mixed and unrecognized breed dogs to participate in the CKC Performance Events of Agility, Obedience and Rally Obedience Trials. The CCN number application form and information on requirements available at: www.ckc.ca (Other Show & Trial forms)

Change to Obedience Rules & Regulations: Open Class

(Effective January 1, 2018)

There are changes to the Obedience Trial Rules effective January 1, 2018. However, we want to provide advanced notice regarding the change to the Open Class A & B.

Exhibitors will now have options within the Open A and B classes and still achieve the same titles.

The Open A Class and the Open B Class will each have 2 options. Exhibitors must indicate on the entry form which option they choose when they complete their entry form.

In Open A, exhibitors can choose between entering into Open HA (which remain as in the existing rules as Open A), or Open 18A (which also follows the existing rules except that the Long Sit is replaced with Change of Positions Exercises, and the Long Down is replaced with a Group Sit-Walk around.)

In Open B, the exhibitor can choose between entering into Option HB (which remain as in the existing rules as Open B), or Option 18B (which adds in the new Change of Position Exercises).

The Options in Open A

Open HA	Points	Open 18A	Points
Heel Free and Figure Eight	40	Heel Free and Figure Eight	40
Drop on Recall	30	Drop on Recall	30
Retrieve on Flat	25	Retrieve on Flat	25
Retrieve over High Jump	35	Retrieve over High Jump	35
Broad Jump	20	Broad Jump	20
Long Sit	25	Change of Positions	30
Long Down	25	Group Sit – Walk Around	20
Maximum Total Score	200	Maximum Total Score	200

The New Change of Position exercises are as follows:

Change of Position Exercises
down-sit-stand-down
stand-down-sit-stand
down-stand-sit-down
stand-sit-down-stand
down-sit-down-stand
stand-down-stand-sit

Example of 1 Routine** See Rulebook for remaining 6 routines

Open HB	Open 18B
a) Heel Free and Figure Eight	a) Heel Free and Figure Eight
b) Drop on Recall	b) Drop on Recall
c) Retrieve on Flat	c) Retrieve on Flat
d) Retrieve over High Jump	d) Retrieve over High Jump
e) Broad Jump	e) Broad Jump
	f) Change of Positions
All routines shall be followed by a Long Sit and Long Down as in Open HA	A Group Sit shall follow all routines – Walk Around as in Open 18A

Thank you to our Sponsors at the 2019 Winter Classic

Diamond Sponsors:

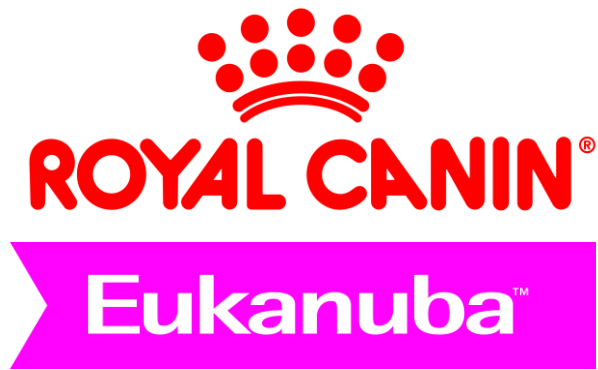

Silver Sponsor:



Bronze Sponsors:



Thank You to Our Advertisers at the 2019 Winter Classic

Silver:



Bronze:



Register for the Winter Classic





and



AKC has teamed up with Ez-clean

Purchase Ez-Clean online through dogshow.ca

50% of the purchase goes directly to the Club

And you get:

“The Ultimate Dog Kennel Odor Remover”

For use in/on:

gravel runs	rubber mats
dog kennels	stock trailers
synthetic grass	barn stalls
real grass	garbage cans
concrete	carpets & upholstery
	laundry



Just spray it on and walk away...its that EZ.

www.ez-clean.ca





Alberta Shetland Sheepdog & Collie Association

Sweepstakes

Friday, January 25, 2019
Judge – Norm LeNeve (ON)

Regional Specialty Show

Saturday, January 26, 2019
Judge – Yvonne Defreitas (WA)

Show Secretary - Susan Badick

88 Greenwood Cres. SW E-mail: badick@ucalgary.ca
Calgary, AB. T3E 4X6 Phone: 403 246-2515

For full ASSCA premium list and entry, go to: www.dogshow.ca

Commercial Booth Information

Booth Chairperson: Marni Kueber
E-mail: marni@darkhorsesdanes.com

Booth Form can be found on our website: www.albertakennelclub.org

Catalogue Advertising

DEADLINE for Advertising copy Monday January 7, 2019 Please contact – Linda Kool @ koolbert@telus.net

****All Advertisements must be Camera Ready – 7 ½” x 10” and be in Black and White****

Only digital files accepted (Microsoft Word Format or JPEG preferred).

The AKC will not be held responsible for copyright infringement. Advertiser accepts all responsibility.

Catalogue advertising dimensions:

Full page portrait: 7.5” x 10” Full page landscape: 10” x 7.5” Business card: 3.5” x 2”
Half page portrait: 7.5” x 5” Half page landscape: 5” x 7.5”

Catalogue advertising is not full bleed.

Payment must accompany all advertisements. (GST excluded from price)

<u>Breeders and Show – Giving Club Rates:</u>		<u>Commercial Rates:</u>	
Full Page	\$40.00	Full Page	\$110.00
Preferred Placement Group Page	\$50.00	Half Page	\$ 70.00
Half Page	\$25.00	Back Outside Cover Page (colour)	\$150.00
Business Card	\$10.00		

****A \$25 fee will apply for advertisements that are NOT Camera Ready and require our designer to fix or format.**

SANCTION and FUN MATCHES

Thursday, January 24, 2019



Conformation Fun Match
Obedience Fun Match Rally-Obedience Fun Match

Registration: 5:00 – 6:00 p.m.

Matches Begin 6:00 p.m.

Cost - \$10 per run



 **Complimentary Chili and a Bun** 
On Thursday evening ~ 5pm

Friday, January 25, 2019

Two Obedience Sanction Matches

Time and cost TBA

Hosted by the Dalmatian Club of Canada and the Western Canada Dalmatian Club

CANADIAN SCENT HURDLE RACING – Saturday, January 26, 2019 after (BIS)



Provincial rep.: Avril Tatterson

Email: avril.tatterson@shaw.ca

Entry Fee: \$10 per team

Number of Teams limited to seven (7)

Please submit entry form together with \$10 entry fee per team to the Show Secretary by 10:00 pm MST, Monday January 7, 2019.

Thank you Cathy French
for our morning coffee



Eukanuba™

Information on Reserving Benching Spaces

The following is a chart which shows how the benching space will be available.
The Alberta Kennel Club is providing reserved and unreserved space for all our exhibitors.

In order to satisfy the demand and give all the opportunity to enter the show,
we have reduced the size of the base unit to 4' x 8'.

Additionally we are asking exhibitors to judge the space needed by the number of expected dogs
per reserved space

We understand that dogs come in different sizes and so will define a “one unit dog” as referring to a medium and smaller sized dog and a “two unit dog” as referring to a large to giant sized dog

For example: Reserve a 480 sq ft space and have 14 medium/small dogs (14x1unit) or 7 large/giant dogs (7x2unit) or any combination of the 2 unit sizes that equals a total of 14-15.

Or a number that is near to that suggestion

Reserving benching space up to a maximum of 480 Sq. Feet				
Prices include GST				
	Cost / space	# Spots	Square footage per space	SUGGESTED # units / space
8' x 12'	\$45.00 x	5	480	14-15
		4	384	11-12
		3	288	8-9
		2	192	5-6
8' x 8'	\$30.00 x	5	320	9-10
		4	256	7-8
		3	192	5-6
		2	128	3-4
8' x 4' spaces intended for individuals with a maximum of 3 together.				
8' x 4'	\$15.00 x	3	96	3
		2	64	2
		1	32	1
4' x 4' spaces are for Obedience and Rally exhibitors ONLY Conformation Exhibitors not allowed in these spaces				
4' x 4'	\$10.00 x	1	16	

Must be ordered online or by mail* only
In this venue, space is limited; please keep exercise pens to a minimum.

Reserved Benching

- *Requests sent by mail do not constitute guarantee of a space.
- All reservations must be submitted online or by mail. No telephone reservations will be accepted.
- We have a limited number of spaces/electrical drops available for prepaid reserved benching.
- **Power is for sale ONLY with a reserved benching spot.**

POWER: \$90 (Prepaid only)
Is ONLY available with a pre-booked benching space, and MUST be booked at time of ordering reserved benching and by the SAME person.

****** Limited Power Available the day of setup – \$100 – Cash Only ******

Adequate unreserved spaces will be available as per the Benching Map on the day of set-up.

The AKC reserves the right to manage the unreserved space

No X-pens will be permitted in these spaces

Guidelines for Reserved/Unreserved Benching

- Benching is offered and designed for the convenience of all exhibitors.
- If you wish to bench with a group of people, please have one person make the reservation.
- **Spruce Meadows does not permit alcohol to be brought into the show building** because of pre-existing sponsorship agreements. This prohibition will be enforced and failure to comply may result in forfeiture.
- Any dogs left overnight, are the express responsibility of the exhibitor/agent. **Contact information must be present in the set-up and clearly visible. The Alberta Kennel Club assumes no liability in this regard.**
- All crates, equipment, chairs, etc. must remain within the limits of designated space.
- **Plastic (Not provided by the Alberta Kennel Club) must be used under and up the sides of all exercise pens. Please plan accordingly; this will be strictly monitored for compliance.**
- Exhibitors are expected to keep their space clean and to leave their benching area clean when leaving the show
- **Fire Lanes/Aisles must be kept clear.**
- All dogs must be exercised in the exercise areas provided for that purpose. Exhibitors are liable for all costs related to cleaning or damage caused by a dog (s) under their control. Failure to exercise appropriate diligence may result in a loss of show privileges.
- **No commercial activity may occur within any space without the express permission of the Alberta Kennel Club Show Chairperson.** Exhibitors are welcome to have signage on pens or crates indicating which breed they have on display.
- All Dog Show Rules and Regulations of the C.K.C. and the Alberta Kennel Club will apply to the Reserved Benching areas. Exhibitors will be expected to accept space as assigned and keep it clean or this privilege may be revoked.
- On Sunday January 27, 2019 the space must be vacated within 1 hour following Best in Show.

Any Reserved Benching remaining unoccupied by noon on Saturday will be made available for use by other exhibitors.

Power is ONLY available with a pre-booked benching space, and MUST be booked at time of ordering reserved benching and by the SAME person.



Reserving Benching & Power

Power is ONLY available with a pre-booked benching space, and MUST be booked at time of ordering reserved benching and by the SAME person.

If you wish to bench with a friend, please have one person book.

If you are booking online and wish to bench with friends, please contact:

Annelise Freeman at freeman9547@gmail.com

We will do our best to accommodate, but cannot guarantee all requests made can be honored

Space is at a premium in this building;

Thank you for your understanding, we appreciate your cooperation

Reserved benching space			
Prices include GST			
	# spaces	Cost/space	total
8' x 12' Max of 5 spaces		\$ 45	
8' x 8' Max of 5 spaces		\$ 30	
8' x 4' Max of 3 spaces		\$ 15	
4' x 4' spaces are for Obedience and Rally exhibitors ONLY Conformation Exhibitors not allowed in these spaces			
4' x 4'		\$ 10	

NAME:	
ADDRESS:	
PHONE:	AMOUNT ENCLOSED:
EMAIL:	

MAIL-IN REQUESTS FOR BENCHING – please indicate which option you prefer

*Requests sent by mail to Erin Verwey do not constitute guarantee of a space.

VGI Show Services Events

243 Mahogany Landing S.E. E-mail: events@verwey.ca

Calgary, AB T3M 1X4 Phone: (403) 803-8590

Entries Close Monday Jan 7, 2019 at 10pm MST

General Information

Entries will be acknowledged after entry closing, with receipt, judging schedule and exhibitor passes. Should such acknowledgment not be received one week prior to the show, please contact the Show Secretary at (403) 803-8590 or events@verwey.ca

Notice of Agreement

The Alberta Kennel Club reserves the right to refuse any entry subject to CKC Conformation Show Rules and Regulations (8.6.1).

In consideration of the acceptance of this entry, I (we) agree to be bound by the rules and regulations of the Canadian Kennel Club and by any additional rules and regulations appearing in this premium list.

I (we) agree to hold the Alberta Kennel Club, their members, directors, officers, agents, superintendents or show secretary and the owner or lessor of the premises and any employees of the aforementioned parties, harmless from any claim for loss or injury which may be alleged to have been caused directly or indirectly to any person or thing by the act of a dog while in or upon the show premises or grounds or near any entrance thereto, and I (we) personally assume all responsibility and liability for any such claim.

I (we) further agree to hold the aforementioned parties harmless from any claim for loss of a dog by disappearance, theft, death or otherwise, and from any claim for damage or injury to the dog, whether such loss, disappearance, theft, damage or injury be caused or alleged to be caused by the negligence of the Club or any of the parties aforementioned, or by the negligence of any other person, or any other cause or causes.

I (we) hereby assume the sole responsibility for and agree to indemnify and save the aforementioned parties harmless from any and all loss and expense (including legal fees) by reason of the liability imposed by law upon any of the aforementioned parties because of bodily injuries, including death at any time resulting therefrom, sustained by any person or persons, including myself (ourselves), or on account of damage to property, arising out of or in consequence of my (our) participation in this show, howsoever such injuries, death or damage to property may be caused and whether or not the same may have been caused and whether or not the same may have alleged to have been caused by negligence of the aforementioned parties or any of their employees or agents, or any other person.

An "In Transit Area" for owner/handlers who are transporting dogs not entered in the show is offered. The dog's information and reason for its presence must be recorded with the Show Secretary and identifying information attached to the dog's crate.

Please note: Dogs shall be exercised only in specified areas provided by the Club. Private exercise pens will be limited.

Owners or agents will not be allowed to exercise their dogs outside or in front of the Dog Show Building. Dogs will also be restricted to the areas of the building designated by the Show Committee.

Dogs should arrive in adequate time for their breed judging (allowing for absentees). It is the responsibility of the exhibitors to have the dog at ringside when the dog's class is scheduled for judging. Waiting for dogs will not be possible and handlers with several breeds must arrange for alternate handlers if judging times for their breeds' conflict.

The Alberta Kennel Club will not allow the use of spike or pinch collars on its show grounds.

If because of riot, civil disturbance or other acts beyond the control of the Alberta Kennel Club, it is impossible to open or to complete the show, no refund of entry fees will be made.

The welfare of an exhibitor's child is the responsibility of the exhibitor. It should be understood that exhibitors will exercise control and restraint over their children. The Alberta Kennel Club will not be responsible for injury to any child whether by accident or any other cause.

ERRORS IN ENTRIES

An error in an age-specified class, date of birth or sex, may be amended up to one hour before the start of the show

Please note: **The show is a public event, candid photos and/or videos may be taken on the show premises. Such images may be published in print or on a web-site without your consent. By entering this dog show, you waive all rights to such images and agree that the Alberta Kennel shall not be held responsible for their use.**

MOVING A CLASS DOG TO SPECIALS

A dog which is individually registered in the records of the CKC or that has a Miscellaneous Certification Number (MCN) and has completed the requirements for a championship in accordance with these rules but at the time of closing of entries for the show has not received confirmation of the title, may be transferred from one of the regular classes to Specials Only providing the transfer is submitted to the Show Secretary in writing by the owner/handler at least one (1) hour prior to the opening of the show. When one or more all-breed championship shows and/or specialty shows are held on the same date in the same venue, the request for moving of class dogs to specials must be made a minimum of one (1) hour prior to the scheduled start of the show for which the dog is being moved up to.

It shall be the duty and obligation of the show-giving club to see that a judge, club official, volunteer, or any participant at an event held under these rules is not subject to indignities. The Conformation Show Committee Chair shall promptly report to the CKC any infringement of this regulation, and the CKC shall have the authority to take such action as it deems fit on receipt of a report indicating that this has occurred

Conformation Show Rules and Regulations (19.7)

ATTENTION FOREIGN EXHIBITORS

EVENT REGISTRATION NUMBER

Effective Jan/1992 all dogs that are foreign-born and foreign-owned and enter Canada for the sole purpose of entering CKC (Canadian Kennel Club) events will no longer require a CKC registration number but will require an ERN - Event Registration Number. This ERN does not register a dog with CKC for breeding purposes as defined in the Animal Pedigree Act but rather enables a foreign-owned dog to be awarded titles by the Canadian Kennel Club. Each dog must have its own number. To obtain an ERN, mail or fax a photocopy of the dog's foreign registration certificate with cheque or VISA/MasterCard number (expiry date, cardholder's name and signature). Provide your complete address for return of the ERN to you.

Cost - \$62.40+ applicable tax. ERN MUST BE APPLIED FOR WITHIN 30 DAYS OF FIRST DAY OF ENTERING A CKC EVENT.

A CKC ERN registration form can be downloaded from the CKC website: <http://www.ckc.ca>

CKC FAX NUMBER (416) 675-6506

For information on traveling with your dogs to Canada, please refer to the following Government Agencies:

Canadian Food Inspection Agency website www.inspection.gc.ca

Canadian Border Services Agency website www.cbsa-asfc.gc.ca

ATTENTION CANADIAN EXHIBITORS – CKC Non-Member Participation Fee

24-12-3. Non-member participation fee

- a) An annual non-member participation fee for awards and titles will be charged to a Canadian non-member of CKC. The fee is **\$62.40 + applicable tax.**
- b) In order to protect the awards/titles earned, the non-member will have a choice either to become a CKC member or to pay the non-member participation fee. Failure to comply within 30 days of notification will cause all awards and titles to be cancelled.
- c) **"these fees apply only to dogs wholly owned by Canadian resident non-CKC members and are not applicable to CKC members"**

*Please note that the CKC Membership Application and the Non-Member Participation Fee forms are available on the website, <http://www.ckc.ca> under Events and then Event forms on the drop down menu. If submitting a Membership Application, please ensure that you also complete the Non-Member Participation Fee form so that we are aware of the dogs involved.

Mixed Breed or Unrecognized Breed Entries in Performance Events

Amendments have been made to the Agility, Obedience and Rally Obedience Rules & Regulations such that mixed or unrecognized breed dogs are allowed to participate in the CKC Performance Events of Agility, Obedience and Rally Obedience Trials. The amendments are effective July 1, 2014.

A Canine Companion Number allows mixed and unrecognized breed dogs to participate in the CKC Performance Events of Agility, Obedience and Rally Obedience Trials. The CCN number application form and information on requirements available at: <http://www.ckc.ca/en/Events/Canine-Companion> **Cost – 63.40 + applicable taxes**

Extracts From CKC Dog Show Rules

Chapter 8 Entries and End of Show Section

8.2.5 An error in an age specified class, date of birth or sex may be amended on the entry form up to one hour before the start of the show.

Section 8.3.1 Entries: Every dog entered in a Championship show must be one of the following:

- registered with the CKC,
- have an Event Registration Number,
- be eligible for registration with the CKC, or
- if it belongs to a listed breed, it must have a Miscellaneous Certification Number (MCN).

Section 8.4.1 Listed Dogs: If a dog is not registered as in 8.3.1 (a) or (b) but is eligible for registration with the CKC, it may be entered at a show as a listed dog provided:

- that if born in Canada, it is eligible for individual registration;
- that if not born in Canada, is eligible for registration in the records of the CKC.
- that if it is a foreign born and owned dog, an Event Registration Number or CKC registration number is obtain from the CKC within 30 days of the first show entered.

Section 8.4.2 Entry of a listed dog at a show must be accompanied by a listing fee as set by the Board in addition to the regular entry fee.

Section 8.5.1 Acceptance of Entries: If indicated in the premium list, an electronically transmitted entry may be accepted provided the entry is accompanied by a credit card charge authorization.

Section 8.5.3 No entry shall be accepted from or on behalf of any person who is officially known to be expelled, deprived of privileges, debarred or suspended by the CKC or any other registering body for pure bred dogs.

Section 8.5.4 After entries close, no further entries may be accepted, cancelled or substituted other than as otherwise stated in this section or as provided for in case of a postal strike.

Section 8.6.1 Refusal of Entries: The authorities of any show may:

- decline to accept entries for just cause, and/or
- refuse to receive or may remove any dog from the show building on account of disease or viciousness.
- in the case of non-acceptance, refund the fee with the reason for non-acceptance.

Section 8.8.2 Fees: Tendering of a dishonoured cheque or declined credit card in payment of an entry fee shall be considered non-payment of said fee and is an offense punishable by disciplinary action and cancellation of awards.

Section 8.9.1 Moving a Dog to Specials: A dog which is individually registered in the records of the CKC or that has a Miscellaneous Certification Number (MCN) and has completed the requirements for a Championship in accordance with these rules but at the time of the closing of entries for a show has not received confirmation of the title, may be transferred from one of the regular classes to Specials Only providing the transfer is submitted to the Show Secretary in writing by the owner or handler at least one hour prior to the opening of the show.

Section 8.9.2 If it is established that a dog transferred to Specials Only has not completed the Championship requirements, all awards will be canceled and all ribbons and prizes won shall be forfeited. The owner may also be subject to disciplinary action.

Section 8.9.3 When one or more All-Breed and/or Specialty Shows are held on the same day, in the same venue, the moving of class dogs to Specials must be made prior to the scheduled opening of the first show.

Chapter 4 Judges Section 4.1.3 A judge officiating at a show held under these rules shall not be subjected to indignities of any kind during the progress of the show. It shall be the duty and obligation of the club holding the show to see that this rule is effectively carried out.

Section 4.1.6 No person may approach a judge either directly or otherwise, orally or in writing, to favor his entry. Disciplinary action will be taken against any person who violates this rule or against a judge who fails to report any contravention of this rule to the CKC within 14 days of the act.

Chapter 14 Disqualifying or Excusing Dogs

Section 14.1.2 (a) At his discretion, a judge shall have the authority to excuse or disqualify a dog which menaces, threatens, attempts to bite or bites the judge, another person, or another dog in the ring. When a dog is twice excused on this account, it shall have the status of a disqualified dog.

(b) At his discretion, a judge shall have the authority to permanently disqualify a dog which bites the judge or another person in the ring. Dogs disqualified under this provision will not be eligible for reinstatement. The decision to permanently disqualify a dog must be clearly indicated on the Judge's Disqualification Form.

Section 14.1.4 Once a dog has been disqualified for any reason at a conformation show, it may not be entered or shown at another show until the dog has been reinstated by the CKC. All awards earned by a dog shown in violation of this section will be cancelled by the CKC and the owner of the dog is subject to disciplinary action. A dog disqualified under section 14.1.2 (b) is not eligible for reinstatement.

Section 14.1.5 Any dog that is disqualified under section 14.1.2(a) shall automatically be disqualified from entering in any CKC event in any other discipline until such time as the dog is officially reinstated, if the dog is eligible for reinstatement.

Championship Points and Cancellations

Section 15.1.1 A dog awarded Winners at a conformation show shall be credited with a number of championship points (ranging from 0 to 5) and the number of championship points credited to a dog awarded Winners shall be as provided hereunder.

Section 15.1.2 The schedule to be employed in the determination of the number of points awarded Winners shall be as follows:

Dogs competing*	1	2	3-5	6-9	10-12	13 & more
Points allocated	0	1	2	3	4	5

*Includes the dog awarded Winners.

In counting the number of eligible dogs in competition, a dog that is disqualified, dismissed, excused or ordered from the ring by the judge shall NOT be included in the calculation for championship points.

Section 15.1.3 If a Dog awarded Winners was also awarded Best of Breed then at the show all dogs competing in the breed, including Specials Only, shall be included the total.

Section 15.1.4 If a Dog awarded Winners is also awarded Best of Opposite Sex to Best of Breed, then all dogs of the same sex including those competing for Specials Only shall be included in the total.

Section 15.1.5 If a Dog awarded Winners is also awarded Best of Winners, then all dogs defeated directly or indirectly in the breed shall be included in the total.

Section 15.1.6 If a dog is awarded Winners only, then all the dogs of the same sex in the class competition shall be included in the total.

Section 15.1.7 The number of championship points to be credited to a dog awarded Winners shall be determined by the highest award earned and calculated as per this section.

Clarification: Example of directly or indirectly defeating: If the Winners Bitch is awarded Best of Opposite Sex but not Best of Winners, the Best of Winners Male shall be deemed to have indirectly defeated the Specials Bitches, and is thus entitled to add them to the number of dogs and bitches defeated.

Section 15.1.8 In addition to championship points allocated at the breed level, a dog awarded Winners which also places in the regular Group competition shall be credited with the following additional points provided that the dog was defeated at the Group level.

Number of Dogs Competing At Group Level	Dogs Placed First	Dogs Placed Second	Dogs Placed Third	Dogs Placed Fourth
13 or more	5	4	3	2
10 to 12	4	3	2	1
6 to 9	3	2	1	1
5	2	1	1	1
4	2	1	1	0
3	2	1	0	0
2	1	0	0	0
1	0	0	0	0

Section 15.1.9 A dog may not be credited with more than 5 championship points in a single show:

Section 15.1.10 A breed or class shall not be allowed more than 2 sets of championship points per sex on any day in the same venue.

Section 15.1.11 A dog awarded Winners which also places Best in Show at an all-breed conformation show shall be credited with 5 championship points inclusive of any points earned at the breed and group level.

Section 15.1.12 In order for a dog to be recognized as a Champion and its owner provided with a Championship certificate, the dog must:

- earn at least 10 championship points under at least 3 judges; and,
- be individually registered in the records of the CKC or have an Event Registration Number.
- have earned at least one 2 point win either at the breed or group level.

Hello,

We look forward to welcoming you to the Delta Calgary South from January 25-27, 2019 while you are in Calgary on behalf of the Alberta Kennel Club to attend the Winter Show. Located in the heart of the Macleod Trail Business and Entertainment district, we are within walking distance to great restaurant and shopping. A listing of local attractions can be seen by clicking on [this link](#), and a video of our hotel can be viewed [here](#).

Our hotel is easily accessible via MacLeod Trail and Deerfoot Trail and complimentary parking is available in two spacious lots. In addition to our three on-site dining facilities including a restaurant, lounge and pub, we have two swimming pools and whirlpools, and two well-equipped fitness centres.

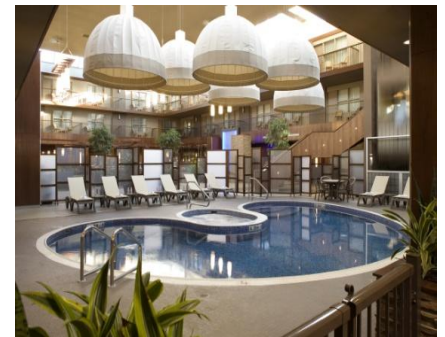

Our **Delta** guest rooms with two queen beds have been fully renovated to include a 42" HD TV enhanced by a proprietary Marriott/GuestTek smart system that carries applications like Netflix and Youtube, and several power outlets on the desk along with four USB ports. The rooms also feature a cordless phone, safe, fridge, microwave, kettle, coffee maker, and iron & board. Wi-Fi and bottled water are free in these rooms.

A preferred rate of **\$129** plus taxes is in place for your group in a courtesy block whereby the special rate will apply as long as we have Delta guest room availability at the time of your reservation request. We do encourage you to contact our Reservations department at your earliest convenience. **A special pet charge of \$20 reduced from \$35**, will apply to your room during your stay.

We are also pleased to extend a **50% discount on breakfast** from 6:30am-9:00am at the Atrium Café. In order to receive this discount, please tell your server that you are with the Alberta Kennel Club.

To request a room within the group, kindly call Reservations at 403-278-5050 or email reservations@deltacalgarysouth.com by Thursday, **December 27, 2018**. Please identify yourself as being with the **Alberta Kennel Club Winter Show-Exhibitors** group in order to qualify for the very special group rate, based on availability.

Cancellation policy for a guest room reservation is 48 hours prior to the day of arrival.

Kind regards,

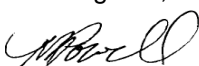

Maria Powell
Senior Sales Manager
[Delta Calgary South](#)



Official CKC Entry Form

Alberta Kennel Club

January 25-27, 2019

MAIL TO:

Erin Verwey 243 Mahogany Landing SE Calgary, AB T3M 1X4

Entries close at 10pm MST on January 7, 2019

Make Cheques payable to AKC or Alberta Kennel Club



Conformation

___ Friday
___ Saturday
___ Sunday

Obedience

___ Friday
___ Saturday
___ Sunday

Rally Obedience

___ Friday
___ Saturday
___ Sunday

\$ _____ + \$ _____ + \$ _____ = \$ _____
Entry Fees CKC Listing fee Prepaid Catalogue Total Enclosed

Breed: _____

Color: _____

Sex: ___ Male ___ Female

Enter in the following classes

___ Junior Puppy
___ Senior Puppy
___ 12 – 18 Months
___ Canadian Bred
___ Bred By Exhibitor
___ Open
___ Specials
___ Veterans (ALL 3 days)
___ Baby Puppy (ALL 3 Days)
___ Exh. Only
___ Exh. Only Baby Puppy

Obedience

___ Pre-Novice
___ Novice A B C
___ Novice Intermediate
___ Open HA HB 18A 18B
___ Utility A B

Rally O

___ Novice A B
___ Intermediate
___ Advanced A B
___ Excellent A B
___ Master

Jump Height: _____

(Please ensure you circle your level as well as marking the class)

Reg'd Name of Dog (CKC Recognized titles ONLY)

Check one and Enter #:

___ CKC Reg. No. ___ CKC ERN No.
___ CKC Misc Cert No. ___ Listed
___ CCN

NUMBER: _____

Date of Birth

____ / ____ / ____
Day Month Year

Place on Birth – Circle one – Canada Elsewhere

On show date – is this dog a Puppy?

___ Yes ___ No

Breeder(s) _____

Sire _____

Dam _____

Reg'd Owner _____

Owners Address _____

City _____

Prov/State _____

Postal/Zip Code _____

Name and address of Owners Agent (if any) _____

Visa ___ M/C ___ AMEX ___ Name on Card: _____

Card Number: _____ Expiry _____ / _____

I certify that I am the registered owner of the dog, or that I am the authorized agent for the owner whose name I have entered above and accept full responsibility for all statements made on this entry. In consideration of the acceptance of this entry, I agree to be bound by the rules and regulations of the Canadian Kennel Club and by any additional rules and regulations appearing in this premium list. I have read and agreed to abide by the terms written in this Premium List.

Signature of Owner or Agent _____

Telephone # _____

Email Address (where ALL confirmations will be sent –
Confirmations WILL NOT be sent via post) _____



BREEDER STANDARD.

At ROYAL CANIN®, we obsess over purebred dogs—and the perfect nutrition for each of them. ROYAL CANIN® formulas are developed with your breed's unique needs in mind for superior body condition, coat health and digestion. As a breed expert, you know the right nutrition can unlock the magnificence inside your dogs, and so do we.

Join the Royal Canin Breeders' Club Today!
Rewards, Specialized Breeder Products, Starter Kits and more.

1-800-527-2673
royalcaninbreedersclub.ning.com

© Royal Canin SAS 2018. All Rights Reserved.



Eukanuba™



AN ORDINARY DOG HAS THE DESIRE.
AN EXTRAORDINARY DOG HAS THE ABILITY.
> THAT'S A EUKANUBA™ DOG.

Eukanuba™
>REWARDS
CANADA

Join the Eukanuba
Rewards Program
1-800-527-2673
www.eukanubarewards.ca