

# Official Premium List



## Working Certificate Tests August 23 & 24, 2025

2 Working Certificate Tests  
2 Working Certificate Intermediate Tests  
2 Working Certificate Excellent Tests

**Open to all Retrievers, Irish Water Spaniels, Poodles, Airedales, and Barbets**

Saturday, August 23, 1 WC, 1 WCI, 1 WCX  
Sunday, August 24, 1 WC, 1 WCI, 1 WCX

**Entry closing date for the August 23 test is August 21 @ 9:00 pm**  
**Entry closing date for the August 24 test is August 23 @ 6:00 pm**

**Location is at the WC Test Headquarters, Regina Retriever Club Pit.** All competitors are to meet at headquarters at 8:00 AM both mornings and **WAIT FOR THE CONVOY** to go to the test.

**Tests will start at 9:00 AM.** All land stakes will be run first followed by all water stakes.

These events held under the rules of The Canadian Kennel Club.

### CLUB OFFICERS

President:	Axton Michial
Vice-president:	Peter Joyce
Treasurer:	Tyler Kuntz
Secretary:	Randy Slawson

### WORKING CERTIFICATE TEST COMMITTEE

#### CHAIRPERSON

Lisa Turk	<a href="mailto:legacy.landscapes@sasktel.net">legacy.landscapes@sasktel.net</a>	639-571-8393
Heather Faulkner	<a href="mailto:riftnaire@accesscomm.ca">riftnaire@accesscomm.ca</a>	306-535-4487

#### EVENT SECRETARY

Louise Yates	<a href="mailto:klanekennels@gmail.com">klanekennels@gmail.com</a>	306-535-6696
--------------	--	--------------

## ENTRIES

*No entries may be accepted, altered, canceled or substituted after the official closing date and time for entries except as provided for in these rules.*

All entries must be accompanied by the entry fee in full.

A separate entry form for EACH DOG in EACH EVENT is required.

Enter online at [www.dogshow.ca](http://www.dogshow.ca) or mail entries (using the official CKC entry form), along with a cheque, payable to the REGINA RETRIEVER CLUB. Cheques are to be dated no later than the closing date.



Mail cheques and completed entry forms to:

Louise Yates

Box 172

Kronau, SK S0G 2T0

E-mail entries will not be accepted.

## JUDGES

Test	Judges	Test	Judges
<b>Saturday</b>		<b>Sunday</b>	
WC @ 9:00am	Lianne Daradics <a href="mailto:rdaradics@accesscomm.ca">rdaradics@accesscomm.ca</a> 306-535-5872	WC @ 9:00am	Patti Kipper <a href="mailto:pkipper@accesscomm.ca">pkipper@accesscomm.ca</a> 306-526-6733
WCI follows WC	Axton Mihial <a href="mailto:axtonjmihial@gmail.com">axtonjmihial@gmail.com</a> 306-737-3365	WCI to follow WC	Yvonne Dyck <a href="mailto:readtherules@yahoo.com">readtherules@yahoo.com</a> 306-280-6738
WCX follows WCI		WCX follows WCI	

## PRIZES

Standard CKC rosettes to all dogs qualifying in each event.

## **ENTRY FEES**

### **Entry Fees**

WC - \$40

WCI - \$45

WCX - \$50

A Temporary Competition Number (TCN) fee of \$10.50 is applicable per dog per event unless the dog's entry carries a CKC individual registration number on the dog being entered or Event Registration Number (ERN) number.

### **Non-Member Participation Fee**

- a) An annual non-member participation fee for awards and titles will be charged to a Canadian non-member of CKC. The fee will match the Event Registration Number (ERN) fee.
- b) In order to protect the awards/titles earned, the non-member will have a choice either to become a CKC member or to pay the non-member participation fee. Failure to comply within 30 days of notification will cause all awards and titles to be canceled.
- c) The Premium List must carry a note stating that these fees apply only to dogs wholly owned by non-CKC members and are not applicable to CKC members.

## **CANADIAN KENNEL CLUB OFFICIALS**

CKC Executive Director: Jeff Cornett, Canadian Kennel Club, 5397 Eglinton Avenue  
W. Suite 101, Etobicoke, ON M9C 5K6

CKC Provincial Director: (Sask.) Val Bandas, R.R. #2, Craven, SK S0G 0W0

Provincial WC Rep: Lynn Campbell, Box 176, Clavet, SK S0K 0Y0

Chapter 14, Paragraph 7, of the CKC WC Test rules state: It shall be the duty and obligation of the test-giving club to see that a judge, club official, volunteer, or any participant at an event held under these rules, is not subject to indignities of any kind. The Working Certificate Test Committee Chair shall promptly report to the CKC any infringement of this regulation, and the Discipline Committee shall have the authority to take such action as deems fit on receipt of a report indicating that this has occurred.

## **TYPE OF BIRDS BEING USED**

Ducks, pheasants or pigeons may be used

**Running order will be randomly selected. Multiple entries by the same owner/handler will be separated.**

There will be no tailgate BBQ.

### **Discipline**

It shall be the duty and obligation of the event-giving club to see that a judge, club official, volunteer, or any participant at an event held under these rules, is not subject to indignities. The Working Certificate Test Committee Chair shall promptly report to the CKC any infringement of this regulation, and the CKC shall have the authority to take such action as it deems fit on receipt of a report indicating that this has occurred. A copy of this regulation shall be prominently placed in every premium list and catalogue.

## MAP TO REGINA RETRIEVER CLUB GROUNDS

Regina Retriever Club Grounds (the Pit)

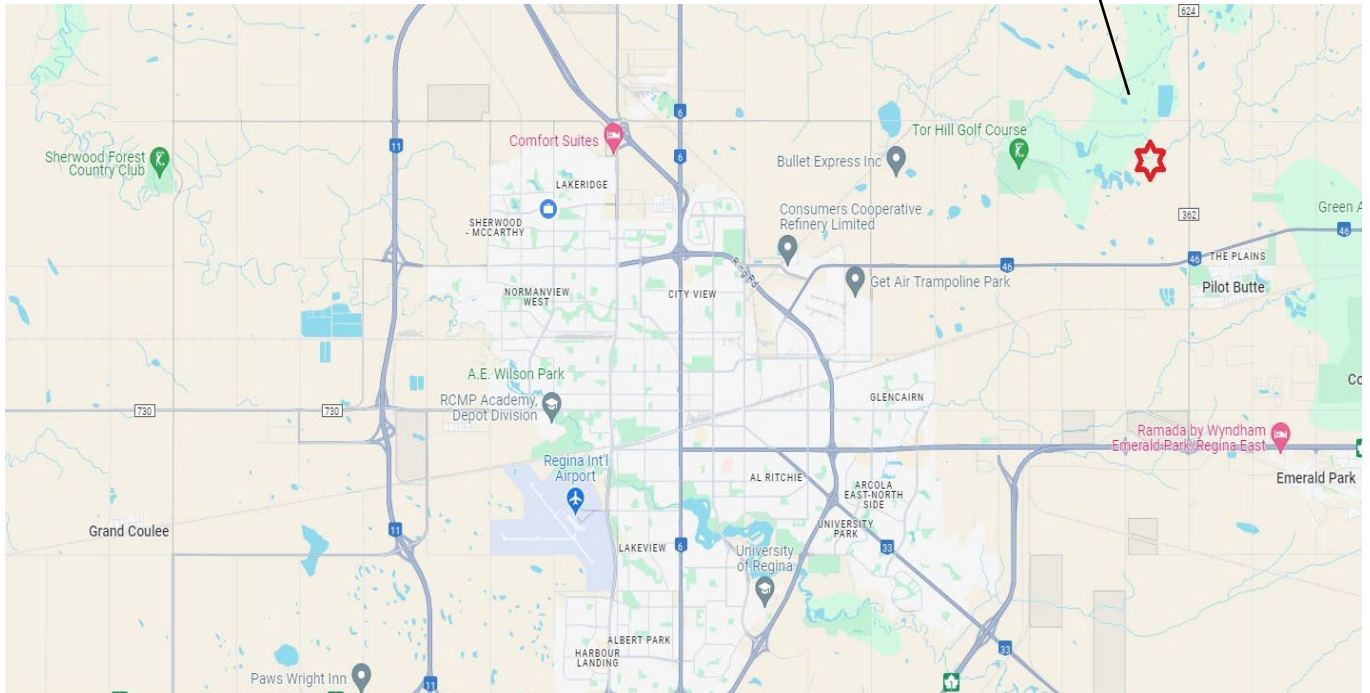

From McDonald Street (Highway 46) 4 miles (6.4 kms) past Fleet Street, turn north, past the construction site and left into the Club Pit.

If you have any questions as to the test location, please contact one of the test committee members for assistance.

**We have confirmed that the below businesses are pet-friendly. You may also find other suitable facility options:**

### **Trailer Parking and Campground:**

- Comfort Plus - 306 781-2810 - 12km east of Regina just off Hwy #1

### **Hotels:**

- Sleep Inn 306-791-1925 Emerald Park
- Days Inn, 306 522-3297
- Regina Motel 6, 306-565-2251 no pet fee